

# Discipline: Kids shape up or stay after

by Ann Hagen  
Discipline and responsibility. How soon should children be taught to mind their manners and learn to be responsible for following directions?

Many elementary school principals, Don Swanson from Brigadoon included, believe the time is now. "Some people say first graders are too young to learn, but when is it time to start?" said Swanson who has been employed by the district for 20 years. "Is it junior high? Highschool?"

A year ago, Swanson adapted an Assertive Discipline program in his school. The program, introduced to him at a principal's workshop at Central Washington University emphasizes positive reinforcement plus clearly stated rules to establish discipline. If the rules are ignored, students are given detention.

In essence, students are informed of rules that individual teachers find necessary to ensure an adequate teaching environment.

Students are given detention after one warning for problems such as not following directions, getting out of their seats, not having their homework in on time, being tardy or being disruptive in class.

Parents are notified that the child will be 15-minutes late for each action. If there is a pro-

blem, the detention can be made up the following day.

LAST YEAR, SWANSON said there was an average of 25-30 students per day detained, 75 percent there because of incomplete homework. At that time, Brigadoon had an enrollment of 775 students, 200 over capacity.

"We've almost eliminated disruptive behavior this year," said Swanson adding that there is now less than 18 students per day in detention. An average of three to five are kept after daily for behavior problems.

PRESENTED TO ELEMEN-TARY principals in August, the program has been adapted either fully or partially by Mirror Lake, Sunnycrest, Lakeland, Camelot and Adelaide Elementaries.

However, some parents say they are shocked over the strict methods used to control the students. Parent Diane Austin, who recently moved from Renton, "the best district in the state" said she is "adamantly opposed."

She has two sons, 9 and 10, at Valhalla Elementary. One son was recently kept after school when he forgot his assignment at home. Though she was not called, he was taken from the school bus bodily and detained, she said.

Another son was detained for losing two tickets that were to

be returned to the teacher.

"Something like this can turn children off completely," she said. "Kids should enjoy school in the primary grades. If you use threats, you'll end up with a bigger problem when the children drop-out. It'll create a situation."

Another parent, with two children at Mirror Lake Elementary complained that the program was regimented



Don Swanson

for those children under the fourth grade. "They are far too strict," she said. "It's more like a military dictatorship."

She added that the "school gives the impression that a lot of parents are for it but I find that hard to believe."

However, both Brigadoon and Mirror Lake principals say that they've gotten good response from parents through surveys.

Last year, Brigadoon principal Swanson said he sent home two surveys, receiving 200 responses from the 775 parents. "They favored detention for classroom disruption at the 85-95 percent level," he said. A second survey in June had the same results though the turn-out was less.

At Mirror Lake, principal Carroll Bagby said he received a similar response from his initial survey.

He reported a 94 percent favorable response from 100 of 350 families responding. His program emphasizes behavior detention at the second grade level and above and detention for homework problems for those third grade and older.

"The entire climate of the school has changed," he said pleased with the way things were working out. "Kids' attitudes are changing to what they were 15 years ago before everything became so permissive," he said.

Though the program was ongoing before Milton Snyder, Federal Way superintendent took over this fall, he said it - that helps students falls in line with the Board's goal to develop a plan to establish student behavior standards.

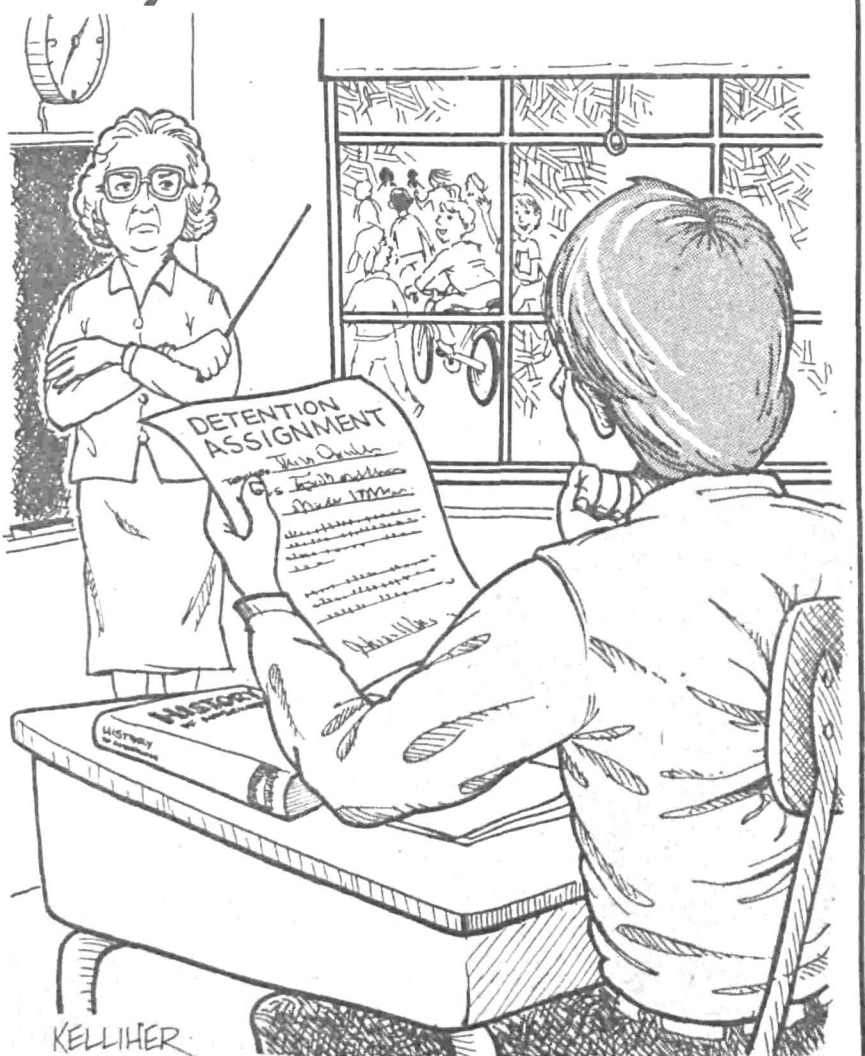

Favoring a positive approach, Snyder said "It's the strong purpose of my profession to see that

children are taught to be responsible both individually and in a group."

Vol. 27 No. 79

Sunday,

October 28, 1979

'Serving the community since 1953'

## Federal Way News

Federal Way, Washington 98003

25 cents



### Crowning glory

"TOO EXCITED and nervous," Federal Way high school student, Michelle Smith, was surprised when she learned she was chosen Homecoming Queen at Friday's assembly. She will reign over the Homecoming festivities.

—photo by Mike Bainter

### Delivery rates raised

A significant increase in the cost of newsprint has made it necessary for the Federal Way News to raise its home delivery subscription rates.

The new charges, effective November 1, will be:

MONTHLY RATE	ANNUAL RATE (paid in advance)
\$2.00	\$20

U.S. mail subscription rates will not be affected by these changes.

## Mandatory shots deadline delayed

Area school children have been granted a few more days of grace as the deadline for mandatory immunization against communicable diseases recently was extended until Nov. 1.

Oct. 21 was the original deadline set for schools throughout the state to comply with the new law requiring immunization of elementary school children. However, organizational problems created by the reams of paper work involved delayed that deadline until the

first of next month, the Federal Way School District reported last week.

That's good news for the students who have not yet been immunized. In Federal Way, that's about one-fifth of the students, Joyce Ray, the district head nurse, said.

The state law requires that all Washington students, grades kindergarten through sixth, show proof of proper immunization or face exclusion from school until they comply to the state Health

Department's satisfaction.

THE REQUIRED immunizations include shots against diphtheria, tetanus (lockjaw), rubella (three day or German measles), measles (hard or seven day), poliomyelitis, pertussis (whooping cough) and mumps.

The law's intent, according to Ray, is to prevent an outbreak of the childhood diseases that can easily be transferred at school.

Students who fail to comply after Nov. 1 will be subject to dismissal. Ray said the list of

those who have not received shots or whose immunizations are not adequate will be sent to the Health Department at that time. The school district then will be advised of which students must be dismissed until they comply with the law.

According to Dr. Paul Chaplik, school administrator in charge of health services, the only factor that can exempt a student from the immunization requirement is that if he or she has a written letter of objection from parents.

## County jail Political scuffle threatens funding

by Darlene Himmelpach  
With the fate of a proposed new jail at stake, King County Executive John Spellman and County Councilman Paul Barden exchanged charges this week that the other was "obscuring the issues."

The battle lines were drawn after Barden threatened to bury an ordinance, crucial to the county getting state money for the new jail, in his committee unless Spellman withdraws opposition to another ordinance that would open selection of the architect to everyone.

Spellman dubbed Barden's efforts "horsetrading" and said "the only way we can assure a poorly planned jail or one which would not be funded by the state is to do exactly what Mr. Barden is doing now."

The county needs "the appropriation ordinance to pay for work on the grant application to the State Jail Commission so we can qualify for state money to build the new jail," Spellman said. "That appropriation (\$70,000) has been held up by Mr. Barden for almost three months" resulting in the county's inability to "obtain cost estimates of various options for the jail and we are facing a January deadline," Spellman emphasized.

He is not alone, Barden said Friday. "No one has pushed for it so it just sat there, I don't support it because I support open competition for selection of consultants."

Barden is peeved because the firm of Naramore, Bain, Brady

and Johnason, chosen by the county design commission to help prepare the county's jail funding proposal to the state. Barden produced a list of various contracts the Naramore firm has had with the county since 1971 without being chosen for the work on a competitive basis. The total for the jobs is \$2.78 million and includes design work on the dome stadium and a White Center Housing study.

Barden alleges that the State Jail Commission rules for granting funds require open bidding but Spellman maintains preliminary design work for the state application is separate from final jail design and is, therefore, not subject to the Commission regulations.

"We have written advice from the county prosecuting attorney verifying that fact. He, not Councilman Barden, is our legal advisor," Spellman huffed.

Spellman also displayed a letter from the state department of general administration showing that Spellman's consultant selection procedure "is substantially in compliance" with the procedure used by that state agency.

"He (Spellman) is simply trying to obscure the issue by claiming I am against the jail," Barden said. Of the "horsetrading" charge, Barden said, "I understand the use of cliches in the political arena. I am absolutely not against a new jail."

What he does oppose, Barden said, is "in a closed process, to just handing over a contract to a firm that seems to have gotten so

much already." Barden has long objected to the position of the design commission in the contract award process which he claims "has resulted in favoritism in the awarding of contracts and I oppose that."

A process which includes a list of "approved" names compiled by the executive, maintained by the director of architecture and selected from by the design commission is a method that assure "hand-picked people would be awarded the contracts," Barden charged. "The executive now

says that everybody can be on the list but three will be chosen for submission to the design commission.

That will never provide others with the opportunity to make bids."

Barden said his ordinance that would open the selection process to bids has "almost unanimous" council support and "when it comes up next Monday, the council will support the ordinance authorizing the jail consultant with the other one."



### Fall back one hour

Daylight savings time ended at midnight last night, be sure to check your clock. Fall back one hour.

## sunday Inside:

Street Talk	A2
Community Calendar	A6
Entertainment	A10
Sports	B1
Real Estate/Class	B5

### Weather forecast

Showers with partial clearing. Highs in the mid 50's lows in the mid 40's. Southerly winds will be gusty, 10-20 mph. Chance of rain 50 percent.



## sports

Federal Way 30, Bethel 0 Mt. Rainier 14, Auburn 6 Lakes 32, Jefferson 8 Decatur 7, Clover Park 14

# Street Talk:

## 'It will probably help the hobos out.'



**Bev Mustered**

I can't take a stand until I know more about it. I really don't understand the thing. I haven't studied it that much.



**Joan Schlagel**

I really would have to read more about it before I made a comment. And I plan to, because I think it's important enough to look into.



**Berni Cousins**

Yes. It will probably help the hobos out. They can collect bottles and live off of that. On the other hand, people won't be throwing them away so much. But the price will go up.



**Clay Tronson**

Yes. It might bring up the price on the bottles a little bit, but I think it will be worthwhile. I'm for it.

Should the state require a five cents deposit on each bottle and can, as set forth in Initiative 61?



**Chris Artman**

Sure. I feel it would keep people from throwing them out the window. I get tired of seeing the junk along the highway. Maybe people will think twice before they do it.



**Bob Kinney**

I don't think so. They have a good program now for gathering up the stuff.



**Ray Husted**

I really don't have an opinion. I would like to see something done to help out the litter situation, but would hate to pay more for pop. I need to find out more about it.



**C.A. Staley**

I'm very, very much in favor of it. If one saw a bottle or can anywhere, he would pick it up. When I was a little girl, the hobos picked them all up because they were worth money.

# Parties agree to UW mediation

by Darlene Himmelspach

An agreement reached behind closed doors this week has paved the way for a possible mediated settlement of the Boeing Company's move to locate its headquarters on the west side of Sea-Tac Airport.

Roger Leed, attorney for the West Side Hilltop Survival Committee, emerged from the session with Boeing and county attorneys in the chambers of Superior Court Judge Barbara Rothstein and reported he was "gratified" that mediation had been agreed to.

A mediated agreement could result in settlement of a lawsuit against the county and Boeing brought by westside neighbors of the airport who oppose the zoning change that will permit the headquarters building on 30 acres near the old Evergreen Tennis Club.

Leed said "we might reach an agreement without the Boeing Company agreeing to do anything" but said the community would like such things as sewer service for the area and the restoration of a five-acre viewing Park that would become the heliport if the existing Boeing plan is enacted.

Leed said a major point in favor of the mediation is that the Port of Seattle, which owns the land in question could be brought into the mediation process although it was not named in the lawsuit. The port owns the land, requested the rezoning that would permit the Boeing development and plans to sell the land to Boeing if county approval of the plan is received.

"This is something we have advocated for a long time," Leed said. "We met with the corporation lawyers at the headquarters and said we wanted to try to talk but they were not persuaded. I am gratified they have been persuaded now."

An "extreme" solution to the problem, according to Leed, would be that the "Port of Seattle could say they would buy the whole area." He conceded, however, that "the people aren't necessarily interested in leaving the area."

If no settlement can be reached through mediation, to be conducted by the University of Washington Mediation Services, trial of the lawsuit will proceed Dec. 3 before Judge Rothstein.

Meanwhile, the King County Council is scheduled to complete a land use appeals committee hearing on the requested rezoning and an unclassified use permit request that would allow the heliport if the office complex is built. That committee hearing, a continuance of one begun two weeks ago, may be delayed until either the mediation is completed or the case has been tried in court.

A spokesperson for the committee said Tom Goeltz, deputy county prosecutor who advises the council on land use matters, will tell the council tomorrow morning if the matter should be continued.

If there is no delay, at least four of the council members will not be allowed to participate in discussions of the rezoning appeal or the unclassified use permit and will not be able to vote on the final proposal before the council. Paul Barden, Tracy Owen, Bill Reams and Bob Greive, all of whom have received major campaign contributions from the Boeing Company, will be excluded from the quasi-judicial process because of a possible conflict with the state Appearance of Fairness Doctrine.

If the committee meeting is held, it will begin at 2 p.m. in Room 402, King County Courthouse. For information on the status of that appeal hearing, call Charlotte Jacobs, 344-3475.

## Fire destroys cycle

Arson is suspected in the burning of a 1974 Kawasaki 500 motorcycle near Southwest 312th Street and Eighth Avenue.

One engine responded to the blaze, bringing it under control in about five minutes. No injuries were reported.

The fire, which was reported by passersby a little before 9 p.m., destroyed the motorcycle.

# Hearty Danish immigrant celebrates century of life

by Brad Broberg

Lured to this country 76 years ago, partially by outlandish get-rich-quick claims, Laura Thomsen found hard work instead of easy money.

Nevertheless, she stayed. And seven children, 13 grandchildren, 23 great-grandchildren and 15 great-great-grandchildren later, she celebrated her 100th birthday Saturday at the Seattle Northwest Danish Home on Des Moines Way South.

More than 150 friends, relatives and dignitaries including the Danish consul and vice consul to Washington, attended the birthday bash.

Earlier in the week, Mrs. Thomsen seemed a trifle embarrassed over all the attention being focused on her.

"I'm going to crawl under the bed," she threatened with a shy smile.

MRS. THOMSEN was raised on a farm in Alborg, Denmark, where she met and married Jens Thomsen in 1900.

They worked a small plot of their own (a wedding gift from

her parents), but soon felt the urge to come to America.

"They told us we could get \$20 gold pieces off the trees, and we sort of believed them," recalled Mrs. Thomsen, a spry woman who retains a charming Danish accent.

She received a somewhat less sensational, but still optimistic, report from a friend who had already immigrated.

"He wrote me, 'Why don't you and your husband come over here? You don't have to work so hard.' He was sort of bragging up America. So we made up our minds to come over here."

Thomsen preceded his wife across the Atlantic to Wisconsin, then sent for her after six months of labor on a farm had enabled him to save enough money for her passage.

The first leg of Mrs. Thomsen's trip from Alborg to America wasn't very pleasant.

She travelled by cattle boat to Copenhagen and was billeted on the second deck below the animals and above the engine.

Between the cattle and the

machinery, "It didn't smell very good down there," Mrs. Thomsen recalled, wrinkling her face into a quick grimace.

Horrified at the thought of another, even longer such voyage to America, Mrs. Thomsen was ready to catch the first train back to the farm when she discovered that the next ship would offer much more acceptable accommodations.

THE THOMSENS lived in Wisconsin from 1903 until 1905, when a generous minister offered them a home and \$30 a month if they would cultivate his land in the Spokane area.

So the hard-working couple went west, eventually renting a 900-acre wheat farm before buying 160 acres of their own 16 miles outside Spokane.

At that time, Mrs. Thomsen was just getting his feet wet in the carpentry trade, so Mrs. Thomsen was in charge of the 160-acre wheat spread.

"I shucked wheat when it was in the shade 101 degrees," she said proudly.

Thomsen eventually prospered as a Spokane contractor and sold the farm. When he died in 1970, Mrs. Thomsen lived for two years on her own in Spokane before moving to the Danish home.

She raised seven children, Mrs. Anna Lindgren and Bob Thomsen of Spokane, Harold Thomsen of Hoodsport and from West Seattle Walter Thomsen, Mrs. Myrtle Swanbeck, Mrs. Mildred Killingsworth and Mrs. Betty Lindmark.

ALTHOUGH she wouldn't name one specifically, if there is a secret to Mrs. Thomsen's longevity, it's obviously hard work.

"I'm used to hard work. If only they would give me a piece of



HOW MANY 3-year-olds can say they have a 100-year-old great-grandmother? Well, Brian Plancich, son of Mr. and Mrs. Michael Plancich of West Seattle, can. His great-grandmother, Laura

Thomsen, celebrated her 100th birthday Saturday at the Seattle Northwest Danish Home on Des Moines Way South. —photo by Gary Kissel

land here so I could grow some potatoes and stuff.

"I don't feel any different than when I was 50. I can't run quite so fast, but I can outrun all of them here," said Mrs. Thomsen, who

keeps busy knitting stocking caps, socks and blankets to sell at the home's bazaars.

Friends say the mellow Mrs. Thomsen never gets mad at anyone, even the fellow Danish home resident who once asked

her, "What do you want to be that old and ugly-looking for?"

"I could get mad at her, but there's no sense," explained Mrs. Thomsen.

"Maybe I'll be that way when I get old."

<b>Federal Way News</b>	<b>Des Moines News</b>
1634 So. 312th Federal Way, Wa. 98003	22307 Marine View Dr. Des Moines, Wa. 98188
Seattle ..... 839-0700	Office ..... 824-4470
Tacoma ..... 927-4353	Circulation ..... 824-4470
Circulation	
Seattle ..... 941-4400	
Tacoma ..... 927-8676	
Classified Advertising	
Seattle ..... 839-9520	
Tacoma ..... 927-2424	
<b>Published every Wednesday, Friday and Sunday</b>	
G.S. Robinson ..... Publisher	Sunday Edition Deadlines
Ken Robinson ..... Associate Publisher	Advertising ..... Noon Thursday
Jim Shahan ..... Editor	Editorial ..... Noon Wednesday
Dick Forster ..... Advertising Manager	Wednesday Edition Deadlines
Nathalie Weber ..... Assistant Editor	Advertising ..... Noon Monday
Agnes Webb ..... Women's Editor	Editorial ..... Noon Thursday
	Friday Edition Deadlines
	Advertising ..... Noon Wednesday
	Editorial ..... Noon Tuesday

## Mini-gymnasts —

# Future Olympic stars?

There may be a few budding Olympic-calibre gymnastic stars in the classes of Marsha Morris at the Des Moines Fieldhouse.

However, even if they don't make it quite that far, the students are developing basic strength and coordination, which Morris said, "is really good for their little bodies".

"The schools are developing their minds," she said, "but they're really not giving too much instruction in developing their bodies at younger ages."

Ms. Morris, who was once the Pacific Northwest Trampoline Champion, said one of her main motivations for teaching the class is to honor the people who spent time helping her out.

One of the things she's teaching the children is to never work out on gym equipment or do strenuous exercise before first warming up.

Once warmed up, the children approach their acrobatics with energy and enthusiasm, which is only natural for budding Olympic stars.

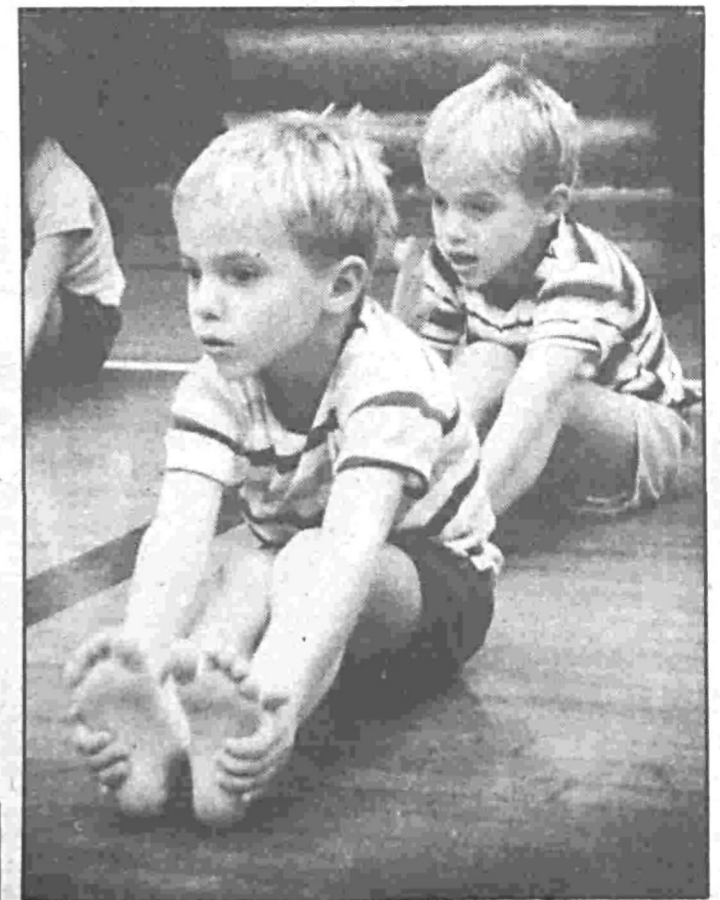

JERRY AND JEFFREY Rice double up while doing their warm up exercise.

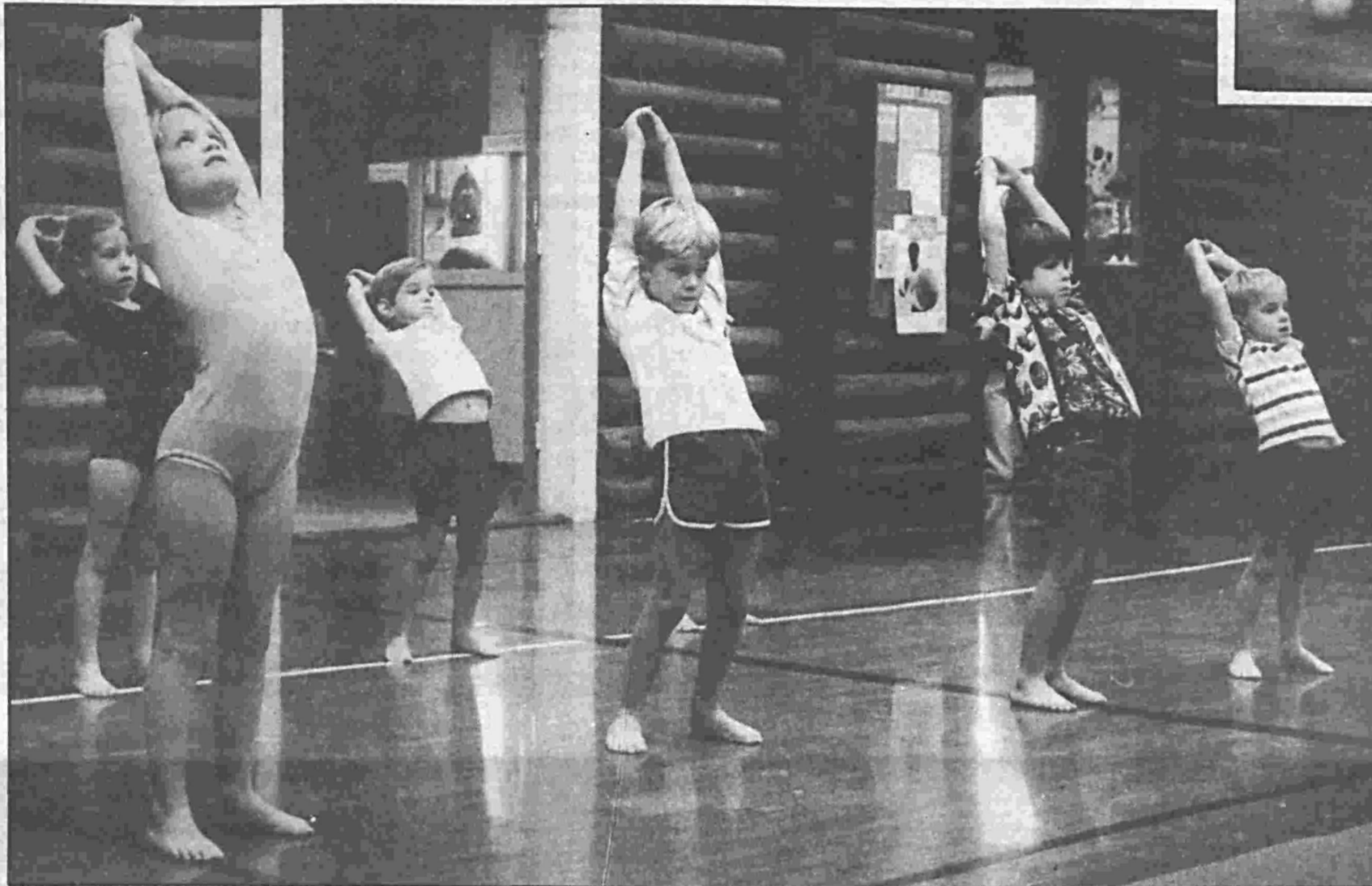

INSTRUCTOR MARSHA MORRIS teaches her young students that warming up before tumbling is essential.



JEFFREY GREWEL, 5, puts out the extra effort to do one more sit up during warm up.

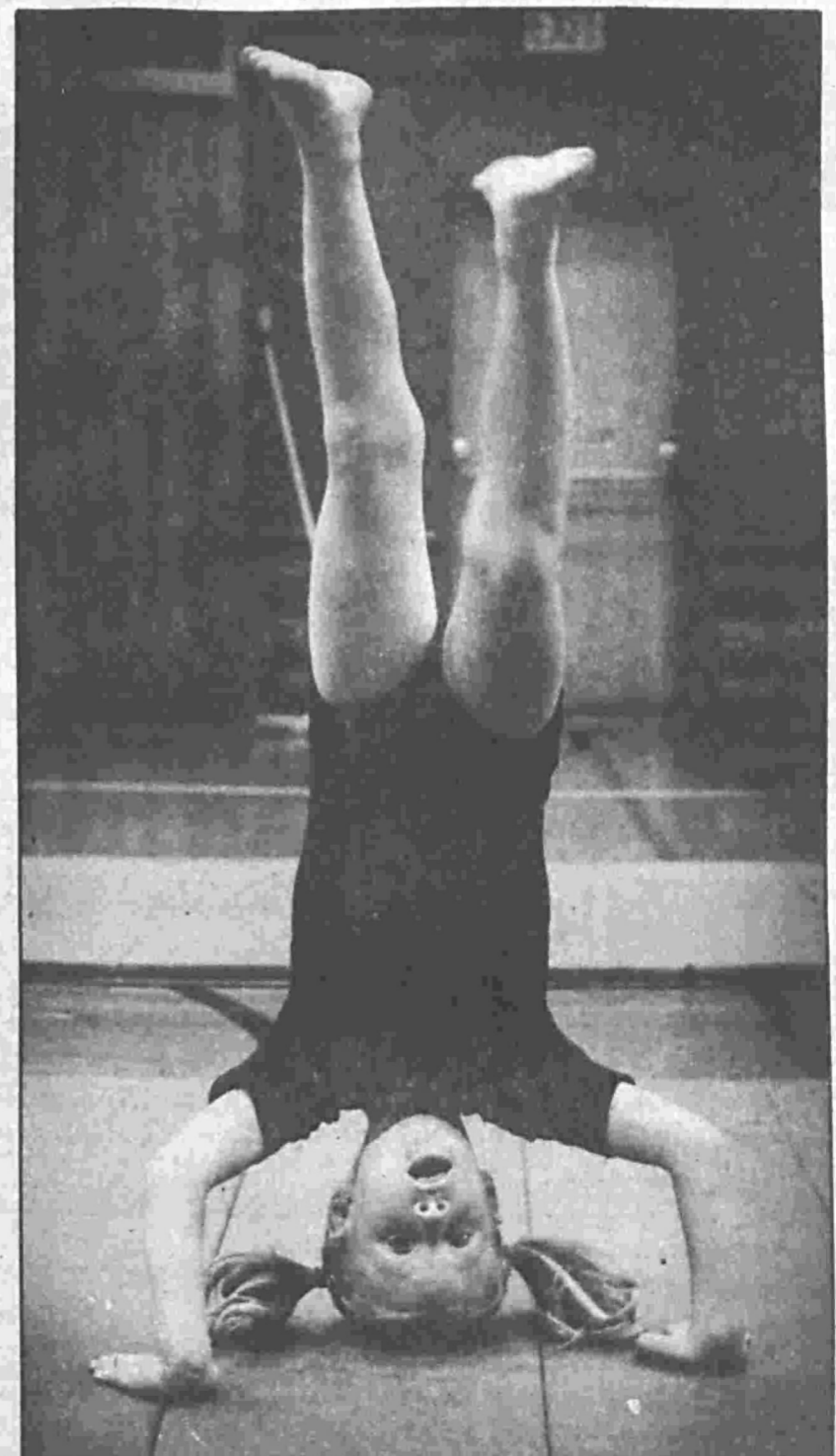

GETTING A DIFFERENT perspective on the world is Michelle Keele, 6.

photos and text  
by Cathy Stone

# Heating with wood: a viable energy alternative



**WOOD FIREPLACES** recently have surfaced as an increasingly popular method of heating a home. Here Jim Walker, a local installer of those fireplaces, checks the temperature of his fireplace, which usually hovers around 195 degrees. When that heat is projected throughout the house, there is more than enough energy to keep the family warm.

—staff photo

by Nathalie Weber

While the future supplies of fossil fuels and electricity lend some uncertainty to home heating in the years to come, there's at least one form of energy that will likely be in hardy supply: wood.

Wood in itself may not seem to be energy, but when stoked in a wood fireplace, it can become the source of heat for nearly any household.

Jim Walker, a local wood fireplace installer, has heated his Dash Point home with wood for nearly a year. One visit to his home attests to the fact that the heat is even and clean, factors often noncharacteristic of fireplace heat.

So what's the difference? Heating a home with a wood fireplace requires installation of a fireplace specifically designed to disseminate heat. Basically, that requires that an air-flow system be included under the fireplace, that transparent doors enclose the fire to retain the heat, and that hot air ducts be installed to carry the heat throughout the house.

This is how it works. When the house temperature drops below the thermostat setting, the system begins to operate automatically. Air is propelled through the sides and back of the fireplace unit, heating the air that then is projected through the house.

The key, according to Walker, is the air flow that maximizes the heat use and minimizes the

amount of smoke that in normal fireplaces often enters the home. "That's the biggest problem in most fireplaces, a lack of combustion air," Walker explained. "Ninety percent of smokey fires are caused by burning in a vacuum."

That vacuum is particularly prevalent in modern homes that are weatherized and insulated. Walker said that the inability of air to get into the house creates the vacuum and, as heat goes up the chimney, smoke is sucked back into the home. The ventilation system in the wood fireplace prevents that from occurring because it alleviates the vacuum.

**THE FIREPLACE** costs \$2,000 to \$2,500 to install, depending upon type of unit desired. It takes about four cords of wood to heat the average home throughout the winter.

So is wood burning a better way to heat. Walker said it depends

upon two factors. The first is the availability of wood. If it cannot be obtained at less than the market price of \$80 a cord, the wood-heated homeowner is looking at a bill of \$320. There are, however, cheaper methods of obtaining wood, such as buying into scrap wood.

The second factor is whether the homeowner is willing to tend the fire. To keep the temperature up, the fire must be stoked three to six times a day, Walker said.

Walker, who services homes west of the Cascades, has installed 30 wood fireplaces for home heating in the past several months. "I've been going like crazy since early spring, but now that winter's coming on it's starting to drop off," he said. But, for those interest, the heating units still can be installed, a process that takes two to three days.

In this day of energy uncertainty, it could be time well spent.

## Green River sets conference

Green River Community College will hold its Fall quarter All College Conference in the Lindbloom Student Center, Wednesday, Nov. 7, from 10 a.m. to 1:30 p.m.

Admission representatives from 20 four-year institutions will be available

to discuss admission procedures and course equivalency policies.

The following schools will be represented: St. Mar-

tins College, Whitworth College, Western Washington University, Walla Walla College, University of Puget Sound, Seattle University, Seattle Pacific College, Pacific Lutheran University, Fort Wright College, The Evergreen State College, Cornish School of Fine Arts, Columbia College, Central Washington University, Antioch College West, University of Portland and ROTC-University of Puget Sound.

from Nautilus, Ruth Koral from Twin Lakes and Pam Williamson from Mirror Lake.

Those interested in running may contact Mawson at 583-5572 weekdays, 927-6726 evenings and weekends.

For more information call GRCC at Seattle, 464-6133, or Tacoma - 924-0180, or Auburn - 833-9111, ext. 294.

Already running for three of the positions are Todd Johnston

## Community Council positions open

Positions on the Federal Way Community Council currently are open for election in mid-November.

Positions, which are elected from elementary school districts, are available in every district, Jim Mawson, first vice chairman of the council, said this week.

The elections are

slated for the evening of Nov. 13. Those interested in running must be 18 years old and reside within the elementary school service area from which they are running. Candidates need not be registered voters.

## CUSTOM DRAPERY SAVE 34% FABRIC, LABOR AND LINED SELECT FROM 53 FASHION COLORS



Average single window 120" width 84" long - Majesty 2 ply luxury satin \$150<sup>48</sup>

PROFESSIONAL DECORATING SERVICE IN YOUR HOME. NO CHARGE. NO OBLIGATION.

839-3686



The Colorful Store That Comes to Your Door

## MEET THE NEWEST MEMBER OF OUR TEAM.



SAFECO is pleased to announce the appointment of the newest member of the SAFECO team. Now, not everyone can become a SAFECO agent. But for those who do, there's a lot to sell — better insurance, for responsible people, at better prices. And that's important these high-cost days.

So whatever your insurance needs are, check with the Panther's new teammate and see if you can save with SAFECO.



**B.K. JOHNSON INSURANCE**  
33239 26th S.W., Federal Way  
Brenda K. Johnson, Agent **838-4553**

# Big Beautiful Eyes Made Easy

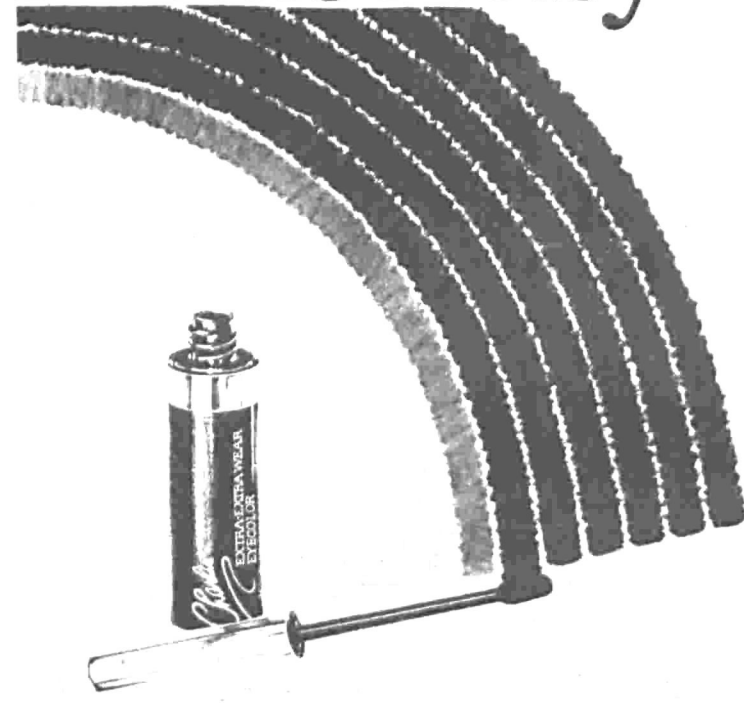

*Charlie*  
By Revlon

Introducing Extra-Extra Wear Eyecolor from the new Charlie Cream On Collection for Eyes. Moisturizing color that goes on evenly and stays on, in 6 dramatic kohlr shades and 3 glowing highlighters.

A smoky smudge here. A soft line there. The beauty possibilities are endless.

And for those of you who wear powder shadows, Charlie has something to help your eyes stay beautiful. Charlie Extra-Extra Wear Shadow Base comes with an ingenious little applicator that gives your eyelids a remarkably smooth surface. So your eyecolor not only blends easily, it lasts too.

You know how you might have gotten those circles under your eyes. Romantic late dimmers. First to see the sunrise.

No reason to let anyone else know. There's Charlie Extra-Extra Smooth Under-Eye Cover. Its special applicator lets it blend so beautifully, circles and lines seem to disappear. It actually helps give your eyes a rested sparkle.



• Cosmetics

*The Peoples Store*  
SEATAC MALL FEDERAL WAY  
SHOP: Mon. -Sat. 9:30 - 9:30 Sun. 11-6

**THE LIGHT AND LIFE CHURCH**  
"A loving Christian Fellowship" presents  
**Bob McGrath**  
in concert  
**SUNDAY, OCT. 28-10:30 A.M.**  
Bob McGrath is well known for Singing the National Anthem at Various Sporting Events in Seattle.  
Worship . . . . . 9:30 a.m.  
Decatur High School  
2800 S.W. 320th **941-1130**

**Sporting T-Bone Tuesday At The Keg**  
The Keg's special aged T-Bone steak.  
The Keg's special aged T-Bone steak.  
The Keg super salad bar.  
Generous portion of deep fried potato skins.  
Sour cream, bacon and chives to dip or dunk those tasty skins.  
It's said the waiters must lift weights to get in shape to carry these scrumptious T-Bones.  
**Every Tuesday Night In Federal Way. 5 to 10 pm. special 8.95**  
**Good Times**  
6 blocks south of SeaTac Mall on Pacific Hwy. S. 838-4100  
Sporting fine food and cocktails (lounge opens 4 p.m.)

*The Peoples Store*  
SEATAC MALL FEDERAL WAY  
*Ladies Velvety Velours...*  
The Softest, Warmest, Most Fashionable Fabric Around Wear It...Wash It...Love It!  
A. From R & K. V-neck, long sleeve with side slit, in ruby. Sizes 10-18. \$48  
B. From Dress Division. Trapunto stitched neckline, long sleeves, side slits. Periwinkle or plum. Sizes 6-14. \$60  
•Dresses  
SHOP: Mon.-Sat. 9:30-9:30 Sun. 11:00-6:00

The Peoples Store

SEA TAC MALL FEDERAL WAY

# EXTRA VALUE DAYS

SHOP: Mon.-Sat. 9:30-9:30  
Sun. 11:00-6:00

LAST TWO DAYS! Sale Ends Monday, Oct. 29th!  
Federal Way 9:30-9:30

<p>Ladies' Vinyl SHOULDER BAG Reg. \$18 <b>14.99</b> Roomy handbags in assorted colors. • Handbags</p>	<p>Bentwood® HALL TREE Reg. \$39.99 <b>19.99</b> Old-fashioned coat and hat rack • Housewares</p>	<p>Ladies Zip-Out LINED PANT COAT Reg. \$50 <b>39.99</b> Polyester pant coat with zip-out liner • Coats</p>	<p>Gemstone No-Iron RUFFLED CURTAINS Save up to <b>20%</b> No-iron blend in natural or white • Draperies</p>	<p>Bentwood® THROW PILLOWS Reg. \$6-\$7 <b>2/\$11</b> Velveteen mix-and-match • Draperies</p>
<p>SALAD SPINNER \$9.99 Value <b>4.99</b> "Spin dry" leafy vegetables naturally and quickly. • Housewares</p>	<p>Ladies Alfiero® COWBOY CLOGS Reg. \$34.99 <b>\$19.99</b> Great looking and super comfortable. Several styles and colors available. • Shoes</p>	<p>14-Kt. GOLD Chains and Bracelets <b>50% OFF</b> Delicately designed Italian gold chains and bracelets for day or evening wear. • Jewelry</p>	<p>Wool Blend LADIES SKIRTS <b>12.99</b> Skirts in assorted plaids, tweeds and solids. Sizes 8-18. • Casual Sportswear</p>	<p>Ladies Pullover SWEATERS Values to \$15 <b>10.99</b> Long-sleeve stripes and solids in turtleneck or johnny collar. Machine-washable acrylic. • Casual Sportswear</p>
<p>Mersco® Junior SWEATERS Reg. \$10-\$12 <b>7.99 to 9.99</b> Turtleneck and V-neck sweaters in solids and turtlenecks in assorted stripes. • Junior Sportswear</p>	<p>Ladies Alice Stuart® POLYESTER BLOUSES Reg. \$25 <b>16.99</b> 100% polyester blouse with fine detail and styling. Assorted prints and solids. • Sportswear</p>	<p>Ladies WARM-UP SUITS SALE <b>19.99</b> Machine washable warm-up suits of triple-knit acrylic, in navy, burgandy or cadet blue. • Sportswear</p>	<p>Cricket Lane® FALL SEPARATES • Slacks, skirts reg. 10.00 ..... <b>8.99</b> • Jackets, reg. 19.99 ..... <b>15.99</b> • Blazer, reg. 22.99 ..... <b>18.99</b> • Blouse, reg. 14.99 ..... <b>11.99</b> • Casual Sportswear</p>	<p>LADIES BRIEFS BIKINIS &amp; HIPSTERS <b>4 pr. 4.99</b> Shiny Antron III® with picot elastic trim. White and pastels in sizes 5-7. • Lingerie</p>
<p>Infants Terry COVERALLS Reg. \$4 each <b>2/\$7</b> Machine washable with snap fasteners. • Infants' Wear</p>	<p>Infant and Toddler BLANKET SLEEPERS Regularly 5.50 to 8.50 <b>4.99 to 7.99</b> Machine washable with full length zipper • Infants Wear</p>	<p>Mens Famous Maker SWEATER SHIRTS Value to \$18 <b>11.99</b> Super-looking shirts of 100% acrylic. Sizes S-M-L-XL. • Men's Furnishings</p>	<p>MENS FARAH SUIT SEPARATES <b>20% OFF</b> 3-pc set: slack, vest and jacket, reg. \$103. • Men's Wear</p>	<p>Men's Royal Knight SWEATER SHIRTS Reg. \$14 <b>11.99</b> Great assortment of stripes and solids. • Men's Furnishings</p>
<p>Men's Flannel SPORT SHIRTS Reg. \$9 <b>5.99</b> Long-sleeve, 100% cotton flannel shirts in plaids of blue, brown, red, green. M-L-XL • Men's Furnishings</p>	<p><b>VELOUR TOPS FOR THE FAMILY 20% OFF</b></p> <ul style="list-style-type: none"> <li>• Mens, reg. \$22 to \$29 ..... <b>17.60-23.20</b></li> <li>• Ladies, reg. \$18 to \$20 ..... <b>14.40-16.00</b></li> <li>• Juniors, reg. \$20 ..... <b>16.00</b></li> <li>• Boys, reg. 11.99 to 13.99 ..... <b>9.59-11.19</b></li> <li>• Girls, reg. \$18 to \$22 ..... <b>14.40-17.60</b></li> </ul> <p>• Men's Wear, Junior Sportswear, Casual Sportswear, Children's Wear</p>		<p>Ladies Boxed Set HAT AND SCARF SALE <b>6.99</b> Waffle weave cuff cap and matching scarf • Gloves</p>	<p>Ladies Vinyl Palms KNIT GLOVES VALUE! <b>2.99</b> Warm double-knit gloves with vinyl palms • Gloves</p>
<p>Decorator Wall Mirrors Reg. \$13 <b>8.99</b> Oblong decorator mirror with gold edge • Stationery</p>	<p>Men's THERMAL UNDERWEAR Reg. 5.50 ea pc. 2 pcs. <b>8.99</b> Long-sleeve crewneck tops and elastic waist bottoms. • Men's Furnishings</p>	<p>Ladies THERMAL UNDERWEAR <b>3.99</b> ea. pc. Cotton/polyester thermals in pastel prints, Size S-M-L • Lingerie</p>		
<p>Ladies' Soft BRUSHED GOWNS Value \$12 <b>7.99</b> Pastels trimmed in lace or embroidery. • Lingerie</p>	<p>Boys' THERMAL UNDERWEAR Reg. 2.79 ea 2 pcs. <b>\$5</b> 50% cotton/50% polyester. Sizes S-M-L-XL. • Boys' Shop</p>	<p>BOYS BRIEFS AND T-SHIRTS Sizes 8-20 Reg. 3/3.99 ..... <b>6/6.99</b> Sizes 2-7 Reg. 3/3.49 ..... <b>6/5.99</b> • Boys' Shop</p>	<p>Men's THERMAL BOOT SOCKS VALUE <b>\$3</b> Acrylic/wool/nylon blend. • Men's Furnishings</p>	<p>Ladies' Cotton Knit SNUGGIES S-M-L ..... <b>2 for \$3</b> XL-XXL ..... <b>2 for \$4</b> Vest, knee pant or over-knee pant. • Lingerie</p>
<p>Gorham Stainless FLATWARE SALE <b>25% OFF</b> 5-Pc. Place Setting reg. \$30 ..... <b>22.50</b> • Stainless</p>	<p>Mikasa CHINA AND CRYSTAL <b>20% OFF</b> • 45-pc. Set, reg. \$175 ..... <b>139.95</b> • Crystal Stemware, reg. 9.95 ea. .... <b>7.95</b> • China</p>	<p>Howell 5-Piece DINETTE SET Reg. 148.95 <b>\$128</b> Table extends to 48" with 12" leaf. • Housewares</p>	<p>Cosco FOLDING CHAIR 13.95 each or <b>4/39.99</b> Folds 4" flat. Tan with gold. • Housewares</p>	<p>Ladies Cotton FLANNEL PAJAMAS SALE <b>8.99</b> Tailored pj's in sizes 32-42. • Lingerie</p>

# Community Calendar

what's happening

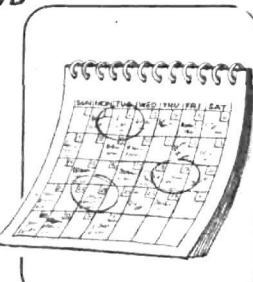

**PUBLIC MEETINGS**  
**Des Moines City Council** (second and fourth Mondays, each month, 7:30 p.m.) Regular meeting at Des Moines City Hall.  
**Des Moines Planning Commission** (first Monday, each month, 7:30 p.m.) Meeting at Des Moines City Hall.  
**Federal Way Community Council** (each Thursday, 7:30 p.m.) Regular meeting in the Lakeside Professional Building, 30819 14th S. (Lower Level).  
**Water District 54** (first and third Monday, each month, 6:30 p.m.) Regular meeting, 922 S. 219th St.  
**Federal Way School Board** (second and fourth Mondays, each month, 7 p.m.) Regular meeting at Educational Services Center, 31455 28th S.

**COMMUNITY EVENTS**  
**South End Singles** (11-3, 9 p.m.) Dance; (11-9, 9 p.m.) "Sadie Hawkins Day" dance; (11-17, 9 p.m.) Dance; Crestview Center, 16200 42nd Ave. S., call 839-5151 for additional information.  
**United Nations Assn.** (being held for four Mondays, starting 10-29, 7 p.m.) Discussions on National Security and the Puget Sound Region, First Unitarian Church, 25701 14th Place S.  
**Crestview C.O.H. Guild** (11-3, 10 a.m. to 3 p.m.) Holiday Project Parade, Sea-Tac Red Lion.  
**South King County Literacy Council** (11-3) Laubach workshop for volunteer tutors, St. Luke's Lutheran Church, 515 S. 312th St.  
**Fife-Milton BPW** (11-7, 6:30 p.m.) Monthly meeting, Poodle Dog Restaurant in Fife.  
**St. Vincent de Paul Altar Society** (11-8, 7:30 p.m.) Mother-daughter fashion show, Decatur Performing Art Theater.  
**Twin Lakes Country Club** (11-9 at 10 a.m. to 10 p.m., 11-10 at 10 a.m. to 6 p.m.) Holiday bazaar, Clubhouse.  
**Adelaide Elementary School PTA** (second Thursday of each month, 7 p.m.).  
**Alcoholics Anonymous** (Tuesdays and Thursdays, each month, 10:30 a.m.) Ancient Mariner, 31140 Pacific Highway S.  
**American Assn. of Retired Persons (AARP) Chapter No. 937** (second Tuesday of each month, 1:30 p.m.) Regular meeting, Steel Lake Presbyterian Church, 1829 S. 308th St.  
**Altrusa Club of South King County** (first and third Tuesdays, each month, 6 p.m.) Dinner meeting at the Fog Cutter South.  
**Bethel 87, Job's Daughters** (second Monday and fourth Saturday, each month, 7 p.m.) Pyramid Masonic Temple, 1700 S. 340th St., for additional information call Wanda Gosland, guardian, 833-5652.  
**Alpha Delta Kappa, Alpha Theta Chapter** (second Thursday, each month, 6:30 p.m.) For additional information call Margit Larson at 927-2195.  
**Centerstage Actor's Workshop** (every Thursday night, 8 p.m.) Federal Way Elks Lodge, 31405 165th Ave. S.

**Decatur High School Fieldhouse** (Wednesdays, 7 to 9 p.m.) Handball, basketball, racquetball, badminton, volleyball and indoor jogging facilities are available, bring your own equipment, adults and students welcome, for additional information call 927-6344, 2800 S.W. 320th St.  
**Dee-Cee Toastmasters International** (Wednesday evenings, 6 p.m.) Dinner meeting, Mulligan's Old Place Restaurant, SeaTac Mall, for additional information call Ken Willard, 773-9458, 255-0394 or 839-1755.  
**Des Moines Garden Club** (first Monday each month, 10:30 a.m.) Meeting, Des Moines United Methodist Church.  
**Dale Leroy Watkins Auxiliary for Children's Orthopedic Hospital** (fourth Monday, each month) Meetings in members' homes, contact Terry Engelstad at 839-7175.  
**Des Moines Lodge 245 F and AM** (second Thursday, 8 p.m.) Des Moines Masonic Temple, 2208 S. 223rd St., William Exley - 878-4387, Richard Neal, secretary - 824-1485.  
**Des Moines - Zenith Orthopedic Auxiliary** (first Thursday, each month) Board meeting in homes; (third Thursday, each month, noon) General meeting at Des Moines United Methodist Church.  
**Evergreen Bridge Club** (every Thursday, 10 a.m.) Open franchise duplicate, 1346 S.W. Dash Point Road, call 927-0244 for additional information.  
**Evergreen Conestogas 4x4 Club** (se-

cond Wednesday, each month, 7:30 p.m.) Meeting, Auburn Park, for additional information call Sandy McKee at 927-7188.  
**Experimental Aircraft Assn.-Green River Chapter 441** (third Thursday, each month, 7:30 p.m.) At hangar at 17603 S.E. 292nd Place, Crest Air Park.  
**Federal Way Aerie 3812 FOE** (first and third Tuesdays, 8 p.m.) Lakeland Community Club, 4016 S. 352nd St., new meeting place.  
**Federal Way Auxiliary FOE** (first and third Wednesdays, 8 p.m.) Regular meeting held at Lakeland Community Club, 4016 S. 352nd St.  
**Federal Way Cooperative Preschool** (meets Tuesday, Wednesday and Thursday, 12:30 to 2:30 p.m.) For registration information call Kifanie Hein at 839-0769 or Marguerite Hayes at 852-9236, All Saints Lutheran Church, 27224 Military Road S.  
**Federal Way Evenings Lions Club** (first and third Wednesdays, 7 p.m.) Held at the Fog Cutter South.  
**Federal Way Jaycees** (second and fourth Tuesdays, each month, 8 p.m.) Meetings held at Jaycee Clubhouse, Federal Way Shopping Center.  
**Federal Way Noon Lions Club** (every Tuesday, 12:15 p.m.) Meeting held at the Fog Cutter.  
**Federal Way Women's Aglow Fellowship** (third Tuesday, each month, 9:30 a.m.) Steel Lake Grange Hall, one block east of 298th and Military Road.  
**Foxgloves, University of Washington Arboretum Foundation Study Unit 77** (second Thursday each month, September through May) Membership now open, call Carol Fox, 941-1273, or Audrey Isaacson, 839-8671, for information.  
**Green River Chapter Barbershoppers** (Tuesdays, 7:30 p.m.) Tryout prospects - singing quartets, held at Star Lake Improvement Club, South 272nd and Military Road, Kent-Federal Way.

**Heritage Toastmistress Club** (second and fourth Tuesdays, each month, noon) Meeting held at the Royal Fork, 31845 Pacific Highway S.  
**Highline Business and Professional Women** (first Wednesday, 7:30 p.m.) Board meeting in homes; (second Wednesday, 6:30 p.m.) Dinner meeting at Black Angus in Burien.  
**Hi-Way Toastmasters** (Thursdays, 7 p.m.) Visitors and guests welcome, Pacific Junior High, 22705 24th Place S.  
**Jaycees** (second and fourth Tuesdays, 7:30 p.m.) At Jaycee Clubhouse.  
**Kiwanis of Federal Way** (every Wednesday, noon) New location, The Dynasties.  
**Lakeland Community Club** (first Thursday, each month, 8 p.m.) Regular meetings; (9-20, 6 p.m.) Potluck, 4016 S. 352nd St.  
**Marine Hills Garden Club** (third Tuesday, each month, 7:30 p.m.) Meeting held at Mrs. Maurice Pratts, 915 S. 293rd St.  
**Mary Bridge Speech and Hearing Center** (Monday and Wednesday, by appointment) Free speech and hearing screening, call 839-3470 for appointment, 2450 Star Lake Road.  
**Omega OES 259** (first and third Wednesdays, 8 p.m.) Stated meeting, J. Smith, secretary, for information call 878-8166, Des Moines Masonic Temple.  
**Outriders Off-Road Vehicle Club** (second Wednesday, each month, dinner at 6:30 p.m., meeting at 8 p.m.) Fog Cutter South, 31211 Pacific Highway S., for additional information call Dick Luznick at 839-1234 or Don Emerson at 839-2459.  
**Overeaters Anonymous** (each Monday, 12:30 p.m.) King County Multi-Service Center, 2450 Star Lake Road; (each Thursday, 7:30 p.m.) Trinity Reformed Church, 3807 S. 260th St., call Betty at 878-3027 for additional information.  
**Tops Chapter 642** (each Monday, 7 p.m.) Babysitting will be

available, call Marie at 839-9122 or Pat at 839-1037, Federal Way United Methodist Church, 29645 51st S.  
**TOPS Chapter 780** (each Thursday, 10 a.m.) Des Moines United Methodist Church, call 878-8107 or 878-3410 for information.  
**Washington State Chapter of National Association of Retired Federal Employees** (every third Tuesday of month, noon) Sixth Avenue Baptist Church, Sixth and Fife in Tacoma.  
**Weight Watchers of Federal Way** (classes Monday at 7 p.m. and Tuesday at 9 a.m. and 7 p.m.) For additional information call 525-2323, Masonic Temple, 33848 Pacific Highway S.  
**Widowed - New Life Group** (every third Tuesday, 7 p.m.) For all widowed persons, regular meetings held at the White River United Presbyterian Church, 526 12th St. S.E., Auburn, for additional information call 927-6287, 939-1000 or 833-2990.

quired, call 839-0257 for additional information, at the library.  
**SENIOR CITIZENS Arts and Crafts** (Mondays, 11:30 a.m. to 1:30 p.m.) At center, bring sack lunch, fourth Monday luncheon out, 33324 Pacific Highway S.  
**Bowling** (Fridays, 10 a.m.) At SportsWorld.  
**Cards (Poker)** (Monday through Friday, 10 a.m.) At center, 33324 Pacific Highway S.  
**Ceramic Classes** (Tuesdays, 11 a.m. to 1:30 p.m.) At center.  
**Dance** (every Friday, 1 to 3 p.m.) Ballroom dancing, donations, call Gwen at 927-9031 or 838-3603 for additional information.  
**Homemakers Club Monthly Meetings** (third Wednesday of month, 10 a.m.) At center.  
**Noon Luncheon** (Thursday, 12:15 p.m.) Make reservations by Wednesday, 2 p.m. at center.  
**Pinochle** (Wednesdays, 12:30 to 3 p.m.) At center.  
**Transportation provided** to all activities of the center and for routine shopping and doctor appointments within the Federal Way area. A three-day advance notice for appointments and a one day advance notice for shopping required, for additional information call Gwen at 927-9031 or 838-3603.  
**MULTI-SERVICE CENTER**  
**Immunizations** (10-29, 9 to 11:30 a.m.) Multi-Service Center.  
**Well-Child Clinic** (10-30, 8 a.m. to 4 p.m.) By appointment only, call 833-8400, Multi-Service Center.  
**Well-Child Clinic** (10-31, 8 a.m. to 4 p.m.) By appointment only, call 833-8400, Multi-Service Center.

**Free ESTIMATES** with NO OBLIGATIONS

*insulated glass*

**MOTHER NATURE** won't wait for an invitation to drop in.

**242-2325**  
 15% Tax Credit on 1979 income taxes.

**50% NO-Interest financing** ON APPROVAL OF CREDIT

**Wesman Industries**  
 INSULATED GLASS & STORM WINDOWS

SAVE ON FUEL  
 INSULATED GLASS KEEPS COLD OUT, KEEPS WARM IN.

**WIN A FREE**  
**Trip to LAS VEGAS**  
 for two (includes airfare and room)  
**in our HALLOWEEN COSTUME CONTEST WED., OCT. 31ST.**  
 9:30 PM - 1:30 AM

Come first for dinner: **STEAK DINNERS** from **4.95** (Includes salad bar)  
 Then enjoy our very **DANCEABLE MUSIC** in Davy Jones Locker with **3PM TRIO**

*The Ancient Mariner*

31140 Pac. Hwy. S.  
 Federal Way

**CALL 839-0781**

*The Peoples Store*  
 SEATAC MALL FEDERAL WAY

Salon: Mon.-Fri. 8:30-9:30  
 Sat. 9:30-5:30

**HAIRSTYLING SALON**

**Introductory Offer**  
**Men's Haircut Special!**  
**Just \$5** Expires Oct. 31st.

Offer good with the following stylists:  
 \* Gayle \* Terry \* Jackie \* Fred \*

**CALL FOR YOUR APPOINTMENT TODAY!**  
**Also Featuring at ... Regular Prices**

- NAIL EXTENSIONS
- MANICURES
- FACIALS
- MAKEUP

• SeaTac Mall •  
 CALL FOR AN APPOINTMENT  
 PHONE 927-4700-839-6560

**Sears**  
 WHERE AMERICA SHOPS FOR  
**GIFTS OF VALUE**

**Diamonds... ablaze with savings!**  
**Selected Tradition® diamond fashion rings**  
**20% Off**

Diamonds! Igniting that look in her eye—a tell-tale sign that she sees what she wants—she'll want what she sees sparkling here! Diamond rings for special occasions, simple creations for anytime wear. Settings of 14K gold, priced to fire your generosity.

**SALE \$76 to \$960**  
 Regular \$95.00 to \$1,200.00

	Regular	Sale
A. One .06 ct. Diamond ring	\$170	\$136
B. Three 1/35 ct. Diamond ring	\$235	\$188
C. Sapphire, Diamond ring	\$575	\$460
D. Four 1/30 ct. Diamond ring	\$335	\$268
E. One 1/30 ct. Diamond ring	\$120	\$96
F. Twenty-Two 1/70 ct. Diamond & Sapphire Ring	\$775	\$620
G. Seven 1/50 ct. Diamond ring	\$335	\$268
H. Two .01 ct. Diamond ring	\$95	\$76
J. 1/2 ct. Total Weight Diamond ring	\$1050	\$840
K. Five .1 ct. Diamond & Ruby Ring	\$1200	\$960
L. One 1/6 ct. Diamond ring	\$475	\$380

Images enlarged to show detail.

**Lifetime trade-in**  
 Swear, allow you full cash price paid less (unless of taxes and finance charge) on any diamond jewelry in trade for a higher priced diamond at any time.

**Buy Sears diamonds with confidence**  
 Because diamond weights are seldom identical, where carat weights are shown, they are approximations only. Sears gives you a Carat Weight Certificate which states the exact weight. To one hundredth of a carat, of every center diamond of 1/20 carat or more.

**In our Jewelry Department**

Available at:  
**SeaTac Mall**      **Tacoma**      **Aurora**  
**First Avenue**      **Renton**      **Overlake Park**

**Sears** Where America shops for Value  
 Satisfaction Guaranteed or Your Money Back



# School music program may profit from Seattle Symphony concert

The upcoming Federal Way performance by the Seattle Symphony Orchestra on Sunday, Nov. 4, could be a two-fold blessing. Those who attend the program, one of four "family concerts" planned by the symphony this fall, will be favored with the sweet strains of Rossini, Beethoven, Gottschalk, Gershwin

and Rimsky-Korsakov. And, if attendance is high at the Thomas Jefferson High School performance, a special benefit may accrue to the Federal Way School District's music program. After the symphony's expenses of \$3,200 are covered, the proceeds that are left will go to the

district, to be used solely for music studies. This is not a far-fetched notion, says Jim Mawson, a Federal Way Community Council member and general chairman of the symphony's Family Concert Committee. "Last year we were \$6 short of making money for the district," he said. "This year, we're hoping we can meet our requested share of expenses and make some money for the district, even if we can just buy some sheet music."

The students who were chosen are Heidi Barnes of Federal Way High School (oboe), Steve Kapp of Thomas Jefferson High School (trombone) and Alicia Taylor of Decatur High School (flute). Seattle Symphony associate conductor, Richard Buckley, will be on the podium, and Manu-  
Laureano, the symphony's principal trumpet player, will solo in Haydn's "Trumpet Concerto." Tickets are available locally at the Federal Way Chamber of Commerce, Holiday Music in SeaTac Mall, Book King in Sea-Tac Village, Poverty Bay Wine Company in the Federal Way

Shopping Center and Carousel Coiffures at South 288th Street and Military Road South. Sponsors for the event are the Federal Way Community Council, Federal Way Chamber of Commerce and the Federal Way Festival in the Forest Association.

# Barden, Reams spar over Medic 1 levy

by Darlene Himmelpach  
If a proposed property tax to help the financially troubled Medic One program in King County is dumped by the voters Nov. 6, the county may "take money from police" to help fund the program one county councilman said Friday.

Bill Reams, the chief proponent of the paramedic system for years, made the veiled threat in response to comments by Councilman Paul Barden who maintained that the county will not let the level of service for the six provider groups slip no matter what the voters do.

Council sparring on the ballot issue followed a progress report to the committee of the whole by Dr. Lawrence Bergner, director of the Seattle King Health Department. Bergner said the survival rate among heart attack victims has tripled since the county started its paramedic program in 1975.

"With paramedic services, 20 percent of cardiac arrest patients were resuscitated and discharged from the hospital. Without this type of service, only six percent survived," Bergner said. Basing statistics on a three-year study of the suburban King County program, Bergner said "we are saving lives at the rate of 65 per year" since the sixth provider group in Federal Way-Auburn joined the ranks this year.

Dr. Mickey Eisenber, director of the three year study, said "Paramedics are indeed miracle workers in their ability to bring clinically dead people back to

life." First response to a cardiac emergency is the key, according to Judy Pierce, manager of the county's emergency medical services. First response is provided by fire department aid units and followed by a Medic One unit staffed with paramedics. "If we can make the first response in four minutes and get the paramedics there within eight, survival reaches forty percent," Pierce said.

Barden, who has opposed the \$.21 per \$1,000 assessed valuation levy, said later "it is unacceptable to me" that Bergner was "inferring that people would lose Medic One if the levy fails." He said he wasn't sure what Reams meant by his comments in the council chambers. "It was unclear to me what his message was. We have got a more than \$200 million budget (pending council approval) and, of the new money raised if the levy passes, about \$4 million would come to the county. That can be found somewhere in the budget."

Barden said that could be done without sacrificing any police funding and said he voted against placing the levy issue on the ballot "because holding ransom the highest priority is not good government."

The chairman of the operations, police and judiciary committee also predicted that "the public safety budget passed by the county council will be significantly higher than that requested by the executive."

The funds in question will come from individual tickets, priced at \$2.50 for adults and \$1.50 for children, and from special "Gold Tickets," which cost \$25 for businesses and \$10 for individuals. Both tickets will admit individuals and their immediate families to reserved seating at the concert, Mawson said. And a "Gold Ticket Reception" will be held at the Thomas Jefferson cafeteria on the afternoon of the performance.

As part of the family series, three young musicians from the district have been selected to join the orchestra in Rimsky-Korsakov's "Scheherazade."

Reservations are now open for booths at the fourth annual Hillcrest Elementary School PTA arts and crafts fair to be held in Renton from 2 to 8 p.m. Friday, Nov. 16.

Craft fair booths available

Save up to 11% on homeowners insurance  
Call me about State Farm Newer Home Discount  
**Paul R. Hunter**  
33600 Pac. Hwy. So. Federal Way  
838-4902

## ACT NOW... 20% OFF

### MEMBERSHIPS DURING OUR OPEN HOUSE HALLOWEEN PARTY OCTOBER 31st, 5-9p.m.

**WE'LL HAVE: Drawings for free gifts and Refreshments**

**NO OTHER CENTER WILL OFFER SUCH A COMPREHENSIVE FITNESS PROGRAM-** See the total picture in action, via video, at our Open House Halloween Party!

**125 So. 156th HOURS: 10-9 242-9641**

FAMILY FITNESS CENTERS

## THE BON

**20% off**

Save on our entire stock of diamond solitaires, diamond wedding bands, and diamond fashion rings.

These are just a few of our favorite rings...diamonds that dazzle, adorn and delight from our extensive collection. This week only, save on diamonds that sparkle in solitaire settings, in clusters and sprays and combined in rainbows with emeralds, rubies, sapphires and semi-precious stones. The entire collection is 20% off this week only, at the Bon. Fine Jewelry, all stores except downtown Everett. Items pictured are representative and not necessarily in all stores.

Charge it today at The Bon. A unit of Allied Stores.

## ...CAN IMPROVE YOUR VIEW

**our 40th year**

**FINE CUSTOM DRAPERIES**

**40% OFF** 20% - 30% OFF ON OUR BEST DRAPERY LININGS

OVER 500 TO CHOOSE FROM AT THIS SPECIAL REDUCTION PRICE  
All in a cavalcade of colors and patterns  
Fabricated in our own Allen's workshop.

- Casements • Satins • Jacquards
- Textures • Prints • 118" Sheers

**40th ANNIVERSARY SPECIAL INCLUDES: FREE INSTALLATION**  
ON OUR FINE CUSTOM DRAPERIES

**FINE CUSTOM BLINDS**

**30% OFF**

**OUR LOVE IS 1" BLINDS**

TOPPED OFF WITH THE NEW VALANCE AT NO EXTRA CHARGE.  
3 WEEK DELIVERY for production on 63 special colors.

**ENERGY SAVING WAYS WITH WOVEN WOODS**

**30% OFF** by Kirsch

**20% OFF**

- LOUVER DRAPERIES
- VEROSOL SHADES
- ALL ROLLER SHADES
- 1" WOOD SHUTTER BLINDS

2004 WESTLAKE AVE. <b>SEATTLE</b> *624-1164	14150 N.E. 20th <b>BELLEVUE</b> *747-9150	1400 South 312th <b>FEDERAL WAY</b> *941-6100	2817 WHEATON WAY <b>BREMERTON</b> *479-6722
---	---	---	---

ALL PRICES ARE OFF SUGGESTED RETAIL PRICES. FINANCING AVAILABLE — UP TO 24 MONTHS

**allen's DRAPERIES & FABRICS**  
"BRINGING HOME THE QUALITY SINCE 1939"

ASK ABOUT OUR WRITTEN GUARANTEE INCLUDED ON ALL PRODUCTS



# Patience stressed by middle school expert

by Brad Broberg  
 Don't expect perfection the first year.  
 That was the message delivered last week to the Highline School Board by a visiting middle school expert.  
 Dr. Donald Eichhorn, superintendent of schools in Lewisburg, Pa., warned the district not to be overly concerned about "having a full-fledged program ready to go next September. I think that would be a mistake because a program as complex as this (middle schools) can't be tied up into a neat package."  
 By next year, all but one of Highline's 7-9 junior highs and all of its 10-12 high schools will be

converted to 7-8 middle schools and 9-12 high schools.  
 EICHHORN'S cautious advice seemed in slight contrast to the district's gung-ho approach to implementation and may have raised a few eyebrows Wednesday.  
 Although it's never been the district's aim to stop work on middle school programs once they are instituted next fall, Eichhorn may have mistaken enthusiasm for that intention, said Highline Superintendent Robert Sealey.  
 "After two days with our staff, I think he got the feeling that we were trying to complete everything this year before next fall," Sealey said.  
 "We are putting quite an em-

phasis on program planning."  
 Eichhorn's advice was actually nothing new, said board member Jim Rice.  
 "We've been told that before."  
 Board member Iris Knapp was also not surprised.  
 "As I understood what he was saying, he was suggesting what is in the plan. I understood him to say don't expect perfection by 1980."  
 Eichhorn said a good middle school program should continue

to develop for 12-15 years after its implementation.  
 A middle school needs a good foundation, which Highline is building, but it must be allowed to evolve, he added.  
 EICHHORN also stressed a second theme — designing programs to fit the age characteristics of the students.  
 "That was the strongest point he made," said Sealey. "The program should be based entirely on

what the students' needs are, not what the teachers' needs are or what the administrators' needs are."  
 Explained Eichhorn, "We spend more time deciding what we're going to do than studying the characteristics of students. What I'm saying is you should take a look at the age characteristics of your children. Then take a look at your program to see if it fits. If it fits, there's no reason to change."  
 One age characteristic of the middle school youngster is a sense of being caught in a web of emotional and physical transitions and Eichhorn repeated a statement from a middle school student to illustrate his point.  
 "When asked to describe a middle school, the youngster said, 'I think a middle school is a school where you are too old to be in

elementary school and too young to be in high school. In other words, it's no fun."  
 BEFORE MOVING to Lewisburg this year, Eichhorn was the assistant superintendent in Upper St. Clair, Pa., which is regarded as having the middle school system, according to Tom Sawyer, Highline's middle school facilitator.  
 Besides hosting Eichhorn, Highline called in another middle school expert last Friday, Dr. Conrad Toepfer, from the University of Georgia.  
 He devoted much of his talk to the theory that the brains of adolescents 12-14 years old take a brief "vacation" from effective learning, reported Sawyer.  
 "They're still learning, but not at the rapid rate they were. You have to tie things closer together," said Sawyer.

## Cable TV to carry Mass

"Bread For My People," the Roman

Catholic Mass produced for television by Catholic Communications Northwest in Seattle, has been placed in the Seattle area on public access cable television.  
 Mary Pugel, programming coordinator for C.C.N., announced that the Mass, which is signed for the deaf, can be seen Tuesday evenings from 6:30 to 7 p.m., beginning Nov. 6.  
 The program can be seen on Channel 3 in those areas served by Viacom Cablevision, and on Channel E in those areas served by Teleprompter.  
 "Bread For My People" is produced weekly by Catholic Communications Northwest for television placement in the Pacific Northwest. The program is part of a growing utilization of the broadcast media by the church. While especially designed for shut-ins

and the hearing impaired, the Mass is intended to project Christian worship to the community as a whole.

Recovery Incorporated (every Thursday, 7:30 p.m.) Self-help mental health group, Auburn YMCA, for information call 631-8518.



### Smokey visits Storybook

FOUR-YEAR-old Ravi Kumar Ayyagari had the opportunity to chat with Smokey recently when he visited the Storybook preschool as part of Fire District 26's activities during Fire Prevention Week.

—photo by C. Stone



### A New Concept in Health Care



Federal Way's Emergency Medical and Family Care Center offers a full range of medical services, on a walk-in basis, at reasonable cost, all in one convenient location.

Our modern medical center is staffed with doctors, nurses, and laboratory technicians on duty 7 days a week, 356 days a year.

We can treat minor ailments and emergencies from common colds, sore throats, fevers, burns, blisters, to cuts, sprains, fractures, and other pains. We can perform complete physical examinations, lab tests, and x-rays, or prescribe medication for common illnesses. And we can provide on-going medical care for as long as you need us.

We've saved a few lives and wiped away a few tears, and now offer the services of a completely equipped and staffed medical center, at a reasonable cost.

**Emergency + Medical Family Care Center**

serving Federal Way

No Appointment Necessary  
 Open 7 Days a Week  
 10:00 AM to 10:00 PM  
 941-5597

320th and Pacific Highway South  
 (across from Sea-Tac Mall)

### SHE SAID TO HIM

"If you want to start your own business you'd better attend this workshop"

So Dave went. During the next eight weeks he learned about marketing, cash flow, finance, site selection, pricing, inventory policy, competition, risk recognition and avoidance, legal structure, and many other important aspects that helped him write a plan for starting his own business.

Was it worth the effort? "You bet!" says Dave, "I've got a plan for my 'Sporting Goods Store in Federal Way that I can show any banker! Or even my wife who told me to do it!"

These ongoing workshops are sponsored by the US Small Business Administration. A new one starts on Thursday evening, November 1, in Federal Way. Call Sonia Ann Beasley at Columbia College for further details.

1-623-4987

What does Dave's wife feel about it? "I'm glad he went." She should know. She grossed six figures in her own business last year.



## northwest design waterbeds

### FEDERAL WAY



### Raintree County Reg. \$949 Now \$899

Finished in Oak. Includes bookcase, headboard, with mirror, deck and pedestal, frame & headboard, mattress, liner, heater.

### Savannah Reg. \$749 Now \$699

Available in Oak finish with bookcase, deck, pedestal, frame, mattress, liner, heater, delivery and installation included.



### Sanctuary II \$360 (Twin)

A soft-side waterbed with full 8 1/2" fill; includes heater. Use your conventional headboard and linens. Hollywood Frames available.

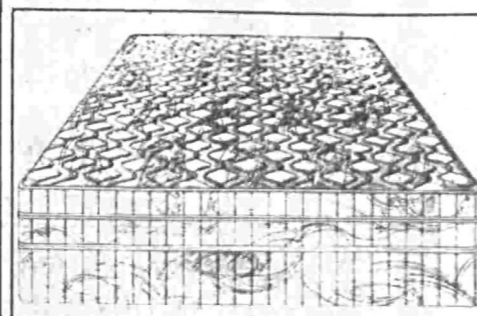

1706 South 320th Street, Federal Way, Sea-Tac Village



### Radost Folk Ensemble at Decatur

THE RADOST Folk Ensemble will perform at Decatur High School in Federal Way on Friday, Nov. 16, at 8 p.m. The local event will be the final stop of the 1979 King County Arts Commission's dance tour. On Saturday, Nov. 10, the ensemble will be at Lindbergh High School in Renton in a program that begins at 5 p.m. The second stop on

the tour will be in Carnation at the Carnation Elementary School on Sunday, Nov. 11, at 4 p.m. The troupe, made up of 45 dancers, musicians and singers in ethnic costumes, perform Bulgarian, Croatian, Hungarian and American music and dance.

### Season opens for symphony

The opening concert of the Seattle Youth Symphony's 1979-80 season will be on Monday, Nov. 12, at 8 p.m. in the Opera House.

It is the 20th year that Vilem Sokol has been conductor and musical director of the youth orchestra. He is professor of music at the University of Washington and teaches violin and viola.

On Nov. 12 George Gershwin's Rhapsody in Blue will be played by a guest artist, Peter Lederer, who frequently has played at the Seattle Symphony pop concerts.

The 125 musicians also will play the First Symphony by Seattle

composer Gerald Kechley, Espana by Alexis Emmanuel Chabrier and Ottorino Respighi's tone poem, The Pines of Rome.

Youth Symphony musicians are 13-21 years of age. Members are chosen through open audition. They come from throughout Western Washington for weekly rehearsals, and alumni play in professional orchestras here and throughout the world.

Season tickets for three concerts in the Opera House or tickets for the opening performance on Nov. 12 are available by calling 623-2001.

**SEATAC SIX** 839-3050 (IN THE SEATAC MALL 320th at Hwy 99)  
 TWI-LITE SHOW \$1.50 SHOW TIMES FOR TODAY ONLY  
 (TLS) INDICATES TWI-LITE SHOW - TICKETS ON SALE 30 MIN. PRIOR TO TLS

*Nature accepted them...but the government wouldn't!*

**Mountain Family Robinson**

Starring ROBERT F. LOGAN • SUSAN DAMANTE SHAW  
 WILLIAM BRYANT • HEATHER RATTWAY • HAM LARSEN and GEORGE "BUCK" FLOWER  
 WRITTEN AND PRODUCED BY ROBERT F. LOGAN • STORY BY JOHN CUTLER • EDITOR JOHN WILLIAMS • MUSIC BY ROBERT F. LOGAN • COSTUME DESIGNER JOHN WILLIAMS • MAKEUP DESIGNER JOHN WILLIAMS • HAIR DESIGNER JOHN WILLIAMS • PRODUCTION DESIGNER JOHN WILLIAMS • EXECUTIVE PRODUCERS JOHN WILLIAMS AND JOHN WILLIAMS • PACIFIC INTERNATIONAL ENTERTAINMENT INC. RELEASE DATE: OCT. 28, 1979

**NOW SHOWING**  
 Limited Engagement

Showtimes: 1:30, 3:30 (TLS 6:00 - 1:50)  
 Sorry No Passes 8:00, 10:00

<b>AND JUSTICE FOR ALL...</b> 12:30, 2:45 (TLS 5:30 - 1:50) R 8:00	<b>MOUNTAIN FAMILY ROBINSON</b> 1:30, 3:30, 3:30 (TLS 6:00 - 1:50) G 1:50/8:00
<b>MEATBALLS...</b> 1:45, 3:15 (TLS 5:45 - 1:50) PG 7:45	<b>AND JUSTICE FOR ALL...</b> 12:00, 2:15 (TLS 5:00 - 1:50) R 7:30
<b>A FORCE OF ONE...</b> 1:15, 3:15 (TLS 5:30 - 1:50) 7:30 PG	<b>SKATETOWN</b> 1:30, 3:30 (TLS 6:00 - 1:50) 8:00 PG

REDUCED ADULT & STUDENT PRICES FOR TLS TICKETS. LIMITED TO SEATING

### Actress to lecture

Kitty Carlisle — actress, singer, lecturer and panelist — will speak in Tacoma on Tuesday, Oct. 30, at 11 a.m.

The hour-long talk, part of the Tacoma Town Hall Lecture Series, will be held at the Tacoma Elks Lodge at 19th and South Union.

Information on subscriptions for the series (\$20), sponsored by the Women of St. Mary's, Episcopal Church in Lakewood, may be obtained by calling Miriam Innes at 845-8475.

# Goblins will be Goblin'

for 59¢ at our special Halloween Night Buffet

5:30 p.m. to 8:30 p.m.

Children 11 years old and under, dressed in Halloween Costume, can treat themselves to all the great pizza and salad they can eat plus a children's soft drink and Treats for only 59¢. Trick 'r treat at Pizza Inn. You could be served by a witch, a monster or even Count Dracula! And Mom & Dad can take advantage of the Halloween Buffet for only \$2.59 each.



**Pizza inn.**

31406 Pacific Hwy. S.



**Noon Buffet**  
 Monday Thru Friday

**2 for the price of 1**

Special Introductory Offer

Two for one noon buffet

Bring this coupon and a friend. You both can enjoy all the pizza and salad you can eat during our regular Noon Buffet, from 11:00 a.m. till 2:00 p.m. You pay the regular price of \$2.59... your friend eats free. Present this coupon with guest check.

Valid thru OCT. 31st

FIP 49

Coupon Not Valid for TUESDAY NITE BUFFET

**Pizza inn.**

Find Inner Piece at **Pizza inn.**

31406 Pacific Highway S.  
 941-3720

### Circus arts workshop:

### Fifth-graders trade treats for tricks

by Barbara Butts  
 Giving up soccer and Halloween usually is a substantial sacrifice for a 10-year-old fifth-grader.

But that is what Cameron Kruse is doing this week.

He and five other fifth-graders from Nautilus and Star Lake elementary schools are packing up today to go to Fort Worden State Park near Port Townsend for a workshop in circus arts.

"He was willing to give up Halloween and soccer for it, and that's a big thing for a kid," said Cameron's mother, Susan Kruse.

In return, the students will be trained in magic, juggling, acrobatics, balancing, pantomime, clowning and circus history.

Three-member teams of students from 21 Washington state grade schools have been selected to attend the workshop, which runs from today through Friday (Nov. 2).

Attending the classes from Nautilus are Sue Nesbitt, Allyson Tripp and Terri Ecklebarger, daughters of Radi and John Nesbitt, Leonard and Celia Tripp and Bobbie and Ken Ecklebarger.

Edward Holmes and Autumn Person will join Cameron in representing Star Lake. They are the children of Suzanne and Brian Holmes and Larry Person. Cameron's father is K. Michael Kruse.

Mrs. Geraldine Jobs, a fifth-grade teacher at Star Lake, will accompany the students.

The workshop is part of "Experiences in Creativity," an annual series of workshops and symposia for the state's creatively gifted

students. The series is sponsored by Centrum, a non-profit, cultural organization, and is presented through funding from the Gifted Office of the Superintendent of Public Instruction and the National Endowment for the Arts.

Workshop sessions will be led by members of the Floating World Circus performing troupe.

The troupe's members have taught at the Cornish Institute in Seattle and the University of

Washington's Experimental College. They are well-known in the Seattle area where they have played to numerous audiences.

Area students were selected after an examination of results from the first two

stages of a gifted program being instituted in the district, said a school official.

Asked why she took up the offer, Allyson Tripp said:

"We don't have to act normal, and not acting normal can sometimes be fun."

Come look us over...The remodeling is done and we've got a NEW FACE to show you at our

### Moonlight Sale

SATURDAY • NOV. 3  
 TIL 10:00 PM

- See R2D2 in person
- Win a FREE TRIP TO RENO

DRAWING IN THE MALL AT 10:15 PM (Need not be present to win)

- FREE refreshments in the Mall

**CENTURY CITY SHOPPING CENTER**

LOCATED AT PACIFIC HWY. SO. & 320th



### FOG CUTTER South RESTAURANT 'N STEAK HOUSE

COME TO OUR 4th ANNUAL TRADITIONAL

### HALLOWEEN COSTUME CONTEST

\* 7 DOOR PRIZES

1st PRIZE DINNER FOR 4 W/ CHAMPAGNE  
 6 other prizes

"COSTUME CONTEST IN OUR FOG LIFTER ROOM WHERE POTIONS OF WITCHES BREW & ENTERTAINMENT ARE SUBTLY CONCOCTED FOR YOU"

EARLY WEEK DINER'S SPECIAL

CHOOSE FROM 9 FOG LIFTER SPECIALTIES

**\$4.95**

INCLUDES SOUP OR A TRIP THRU OUR UNIQUE

SALAD BAR



31211 N. PACIFIC HWY. SO. FEDERAL WAY 839-4520

### you're invited to our HALLOWEEN COSTUME PARTY

Wednesday, October 31st 9 PM • 2 AM

- Happy (Witching) Hour
- Special Drink Prices 4:00 PM • 8:30 PM
- Costume Contest
- \$100.00 First Prize
- Make-up a Party and Join Our Halloween Party at



Stuart Anderson's **BLACK ANGUS** RESTAURANTS

2400 so. 320th • Federal Way • 839-8370

"you're going to feel SPOOKY inside!"

# Fred Meyer

SAVE TIME  
SAVE GAS  
SAVE MONEY

## ONE STOP SHOPPING CENTERS



**WHEN A SMILE MEANS SO MUCH**  
Fred Meyer People Are The Friendliest People In Town. They Know That Being Helpful and Friendly Makes Your Shopping Trip Easier. Come In Today For The Best Prices And A FREE Smile.

Prices Good Thru Tues. Oct. 30, 1979

# TRICK OR TREAT SPECIALS

Shop Fred Meyer Candy Sections for All Your Halloween Trick or Treats

- Corn Nut Fun Packs <sup>22</sup> Count
- Fleer Bubble Gum <sup>35</sup> Count
- Reeds Butterscotch or Root Beer Rolls <sup>21</sup> Count
- Four Star Pops <sup>21</sup> Count

Reg. 1.19 **Your Choice**  
**87¢** Dozens of other special Halloween items for you to choose from.

## Hershey's Snack Packs

**YOUR CHOICE**  
Reg. \$2.09  
**1.77** 28 mini bars - Hershey Milk or Almond, 20 Mini Bars - Reeses Butter cups or Crunch Bars. All individually wrapped for passing out or for yourself.

**Halloween Chews**  
Reg. 79¢  
**57¢** 8 oz. bag of orange and black flavored chews. Delicious!

**MY-TE-FINE Candies**  
• Jelly Beans - 14 oz.  
• Gum Drops - 16 oz.

Reg. 79¢ **Your Choice.** Orange and licorice flavored. Soft, tender and delicious.  
**57¢**

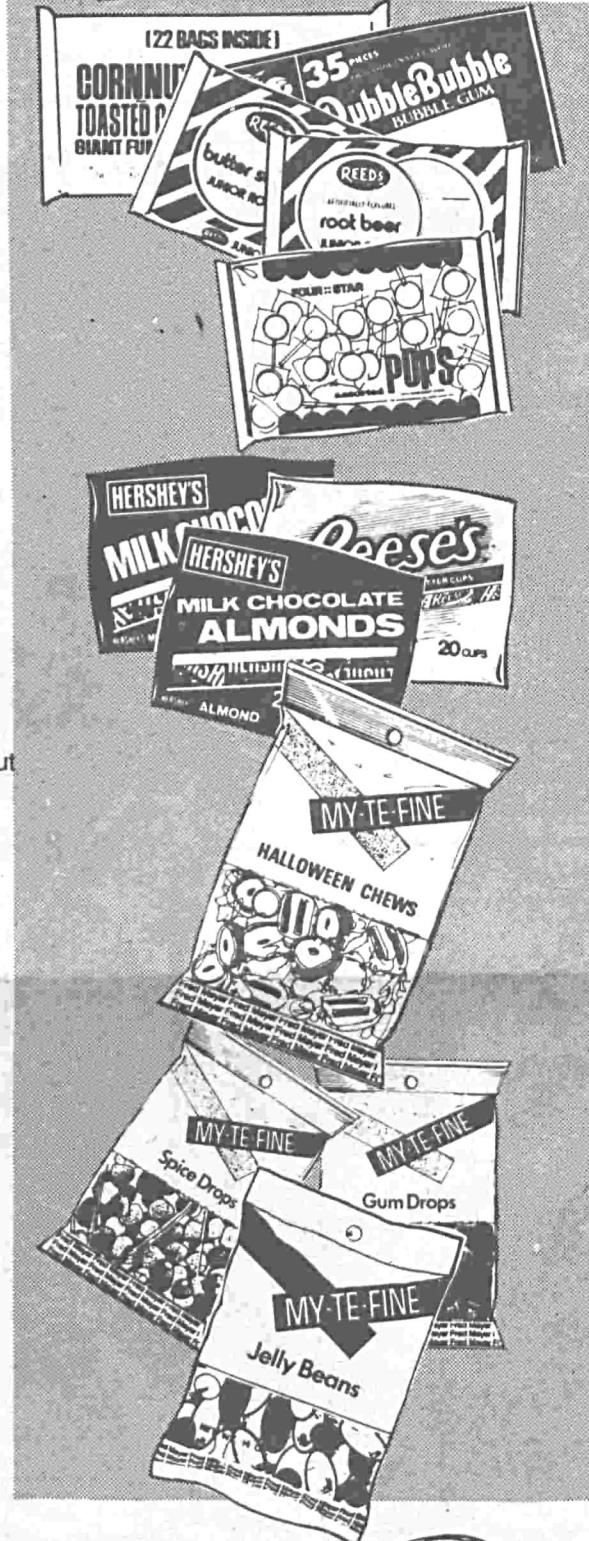

**Stick On Disguises**  
**57¢** Reg. 69¢ Wild and scary pressure-sensitive stick on eyes, open cuts and more.

**10" Blg Jack Carry Pumpkin**  
**1.29** Reg. 1.49 10" molded plastic bright orange pumpkin carrying container  
Variety Sections



**Photo-Sound Savings**  
**Kodak Colorburst 50 Instant Camera**  
Sale Price **29.97**  
Less Kodak Rebate - **5.00**  
**24.97** Your Cost After Rebate From Kodak

Just aim and shoot with the lowest-priced motorized Kodak instant camera. Automatic exposure control, fixed-focus lens. Takes flash or electronic flash (not included). Model 50

**Kodak Electronic Flash** Model C Reg. 26.99 **24.99**  
**Kodak Color Burst Camera Bag** Reg. 8.99 **6.99**

**SALE PRICED**  
**51 Count Foam Cups**  
**2/\$1**  
Ideal for holiday entertaining. Keeps drinks hot or cold. Disposable. Variety Sections

**SAVE 22¢**  
**Halloween Candy**  
**57¢** Reg. 79¢  
8 oz. bag of orange and black chews in assorted shapes. Soft, chewy. Candy Sections

**Sylvania SPECIAL OFFER**  
Buy 2 and get \$1.00 back from Sylvania. See store for details.  
**Flipflash or Magcube**  
**1.47**  
Shoot 5 flash pictures, flip and shoot 5 more. Easy to use.  
Photo-Sound Sections

**Presto "Popcorn Now" Corn Popper**  
Sale Price **26.99**  
Continuous popping with special bin that allows non-stop feed flow (hot air) popping. Butterwell melter automatically butters corn as it pops #PN1 Housewares Sections

**WE will mail you a check FOR UP TO A \$3.00 REFUND\***

EXCEDRIN ANALGESIC TABLETS 100's SIZE **1.83**  
BUFFERIN ANALGESIC TABLETS 100's SIZE **1.57**  
BEER ENRICHED BODY ON TAP SHAMPOO 7 oz. SIZE **1.79**  
BAN DEODORANT 2.5 oz. SIZE **1.69**  
VITALIS LIGHT MOUTHWASH 7 oz. SIZE **1.89**

**WE WILL MAIL YOU A CHECK FOR UP TO A \$3.00 REFUND**  
\*Check appropriate refund:  
- any 3 of the 10 participating brands to get a \$1.00 refund  
- any 4 of the 10 participating brands to get a \$2.00 refund  
- any 5 of the 10 participating brands to get a \$3.00 refund  
OUR VERY BEST FOR LESS REFUND  
P.O. Box 14182  
Baltimore, Md 21203  
PROOFS OF PURCHASE: SEND ENTIRE OUTER CARTON AND CASH REGISTER RECEIPT FOR: Antrhis Strength BUFFERIN\* (any size) BAN\* Roll-On Reg. Unsc. Quick Dry (1.5 oz. 2.5 oz. or 3.5 oz. size) BUFFERIN\* 160's or larger) EXCEDRIN\* 160's or larger) EXCEDRIN P.M.\* (any size except 10's) 4-Way\* SPRAY Regular Menth. Long Acting (any size) VITALIS\* SUPER HOLD™ Regular Hold (any size)  
SEND CASH REGISTER RECEIPT AND TICKLE (2 oz. 1 BODY ON TAP\* (7 oz. or larger) HAND DRAW FACSIMILES NOT MICHAN VITALIS\* Liquid (7 oz. or larger) VITALIS\* ICALLY REPRODUCED OF THE PRODUCT SUPERHOLD™ Regular Hold (any size) NAME AND QUANTITY CONTENT FOR:  
Your check may be made out to you and the store. If it is, when you receive it, bring it in, we'll counter sign and give you your refund on the spot.

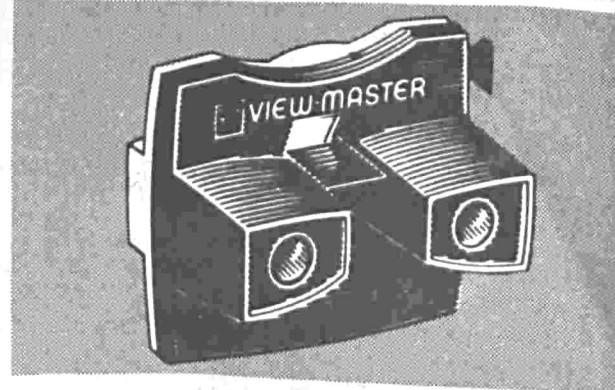

**GAF Standard View-Master**  
**2.29** Reg. 2.99  
Classic 3D viewer made of tough polystyrene in bright red. Easy to use for ages 4 to adult  
Variety Sections

**SPECIAL PURCHASE PLAYWEAR**  
from **DOUBLE B**  
**3.96** ea. Tops  
**4.96** ea. Pants  
Special savings on 4-6x playwear from Double B by Buster Brown. Quality construction that's color coordinated and easy care machine washable. Save now on this extra special price.  
Reg. 9.00 set  
**Now 6.96**  
**Girls' Thermal Underwear**  
Snuggle with Holly Hobbie® or Ziggy® in thermal sets from Inner world. A new look in girls' thermal underwear. Sizes 4-5 to 14-16. Top and bottom set



Each of these advertised items must be readily available for sale at or below the advertised price in each Fred Meyer store, except as specifically noted in this ad.

# Grass Roots Gardening

by Ginna Koontz



The waning October days herald the end of a warm summer and an unbelievable sunny autumn. Take advantage of the next few days to prepare the garden for winter and next spring.

Dig glads, let dry for a couple days then remove foliage. Store in old nylon, mesh onion bags or slatted boxes in a cool dry area. Add an insecticide-fungicide dust. Dahlias are treated in the same manner as glads but wash soil from tubers, write variety names on tuber with grease pencil then place in sawdust, bark or peat moss.

Tuberous begonia bulbs should be lifted from pots and stored in same manner as dahlias. Plant winter flowering kale in the empty pots for winter color.

Although fuchsias are evergreen in their native habitats, the hanging basket varieties we cultivate slow down, cease flowering and loose leaves in autumn announcing they need a long rest to regain energy for the next season. After the first light frost cut stems to two inch stubs and set containers in a cool dry spot. Allow soil to become quite dry but water monthly during winter. The disadvantage of saving fuchsias is that few persons have facilities to force early foliage and flowering so it is July before they bloom again.

Geraniums can be wintered over by cutting stems back to two inch lengths, pots set in cool dim, dry location and watered monthly during winter. Cuttings can be made from the removed stems. Root in a jar of water on the window sill, but cuttings are

sturdier if started in peat-sand mixture. Divide peony plants if needed. Peonies have the peculiar characteristic of poisoning themselves if set back into the same planting hole. Peony plants relish a handful of lime each fall.

If chrysanthemums are planted in containers feed a liquid plant food now.

Harvest late maturing pears, apples, grapes and potatoes. Root crops like carrots, beets, onions, are best left in the garden. Mulch rows with three or four inches of bark, sawdust, compost or soil.

Deciduous trees and shrubs, especially fruit trees, bush fruits and rhubarb should be planted now. Evergreen trees and shrubs also become well established when planted in late October or early November.

Old wood should be cut out of flowering shrubs, including climbing and pillar roses. Top all tall canes on rose bushes to about three feet so canes don't whip in winter winds loosening and damaging roots.

Autumn lawn care is extremely important. Lawn maintenance includes mowing as long as grass is growing, applying a "winter" lawn fertilizer to assist lawn through the rainy leaching winter. Rake falling leaves frequently. Left laying on the turf, leaves may rot the lawn and also harbor injurious diseases and insects.

Remember to water all plants growing under eaves. Clean up garden debris and rogue out weeds. Garden sanitation prevents many pro-

blems. Keep slug bait out, replacing monthly.

Spreading herbicide weed killers (Carson, trade name) according to label directions is especially effective in the cool

autumn. Do not use where it can leach into lawns. Do not use in bulb or herbaceous perennial beds.

Container plants must be protected during freezing weather. The plants

are generally hardy but roots do not have the protection of Mother Earth. They live only in a thin walled container and a little soil. Wrapping containers with a two inch thickness of

newspapers, stapling or tying in place usually affords sufficient frost protection. Set in protected spots outdoors but remember to water if under overhangs or eaves.

Of course, soon all autumn chores will be completed but keep in the gardening mood and abreast of all that's new in the gardeners' world by sending for

reputable mail order growers. The names are advertised in all garden magazines: Sunset, Flower and Garden, Better Homes and Gardening, Organic Gardening, etc.



# Payless

Sunday • Monday • Tuesday

Prices Effective Now Through October 30, 1979

HOURS  
MF-9 to 9  
SAT-9 to 7  
SUN-10 to 6

<p><b>TOOTSIE ROLLS</b> Tootsie Roll Miniatures for Halloween!</p> <p>Bag of 160 Reg. \$3.29</p> <p><b>2.49</b> Bag</p>	<p><b>Bumble Bee TUNA</b> Fancy Albacore solid white tuna packed in water.</p> <p>7 Ounces</p> <p><b>99¢</b></p>	<p><b>Your Choice CANDY BARS</b> Your choice of assorted M&amp;M-Mars, Fun-Size candy bars for Halloween.</p> <p>Reg. \$1.99</p> <p><b>1.49</b> Bag</p>
<p><b>Hunt's TOMATO SAUCE</b> Thick, rich tomato flavor. For spaghetti, sauces, etc.</p> <p>15 Ounces</p> <p><b>3 for 1</b></p>	<p><b>SPAM</b> A favorite for quick, ready-to-fix meals. Makes great sandwiches!</p> <p>12 Ounces</p> <p><b>1.09</b></p>	<p><b>Coleman FUEL</b> Fuel for gasoline camping appliances.</p> <p>1 Gal</p> <p><b>1.89</b></p>
<p><b>Nestle CHOCOLATE MORSELS</b> 12 oz bag, great for holiday baking.</p> <p><b>1.77</b> Pkg.</p>	<p><b>Pacific Friend SHRIMP</b> Taste great in salads, casseroles &amp; sandwiches!</p> <p>4 1/2 Ounces Reg. \$1.29</p> <p><b>99¢</b></p>	<p><b>Kraft CARAMELS</b> Great for making caramel apples!</p> <p>14 Ounces Reg. \$1.09</p> <p><b>79¢</b></p>

## Library offers more than books

The Des Moines Library will be pushing more than books during National Children's Book Week, Nov. 10 through 17.

Through a project called "Arts Express" staff members will try to expose school-age children and families to the widest possible range of visual and performing arts experience.

The first workshop, taught by Johanna Maas will be the study of design by looking at a shoe. The art workshop, for children grade three and up, will meet Nov. 13 at 4 p.m. Pre-registration is required.

A children's voice workshop is scheduled for Nov. 15 at 7 p.m. with singer Jane Cater. The workshop, for school-age

children, will include vocal warm-up exercises, humor in music, and songs in other languages.

For more information, contact the Des Moines Library, 824-6066.

## Cubs host scary party

A Halloween party and haunted house will scare and delight youths, 12 and under, tomorrow, Monday at the Des Moines Fieldhouse.

Both activities are free, courtesy of Cub Scout Troop 369.

The party will be from 5 to 6 p.m., followed by the haunted house from 7 to 8 p.m.

## Spooktacular Coupon Buys - Our 'Treat' for You, FREE!

<p><b>Payless Valuable Coupon</b> Coupon Cash Value 1/20 of 1c</p> <p><b>Royal GELATIN DESSERT</b> Ass't flavors</p> <p>3 oz box</p> <p><b>6 for 1</b></p> <p>1 ROLL PER CUSTOMER</p>	<p><b>Payless Valuable Coupon</b> Coupon Cash Value 1/20 of 1c</p> <p><b>Scott TOWELS</b> 85 sq. ft.</p> <p><b>57¢</b></p>	<p><b>Payless Valuable Coupon</b> Coupon Cash Value 1/20 of 1c</p> <p><b>Kodak COLOR FILM</b></p> <p>12 exposure rolls of 126 or 110 size color print film.</p> <p>Reg. \$1.39</p> <p><b>1.17</b> roll</p>
---	--	--

All items and prices in this advertisement available only at:

**Payless Federal Way Shopping Center**  
31401 Pacific Highway So 839-9000 R X 839-6240 Tacoma 927-2602

Each of these advertised items is required to be readily available for sale at or below the advertised price in each Payless Drug Store except as specifically noted in this ad.

**Fabricland**

**ALL PATTERNS 1/2 PRICE!**

VOGUE, BUTTERICK, McCALL, SIMPLICITY

(Limit 2 per Customer)  
Offer Ends 10/30/79  
32065 Pacific Hwy. So.  
Century City Shopping Center  
927-7110



JOHN BRIGGS, of Decatur, gets upended on a punt return by Clover Park's John Kees during Thursday's SPSL contest. Decatur coach Greg Flynn (right) expresses concern about such hard hitting. He also was

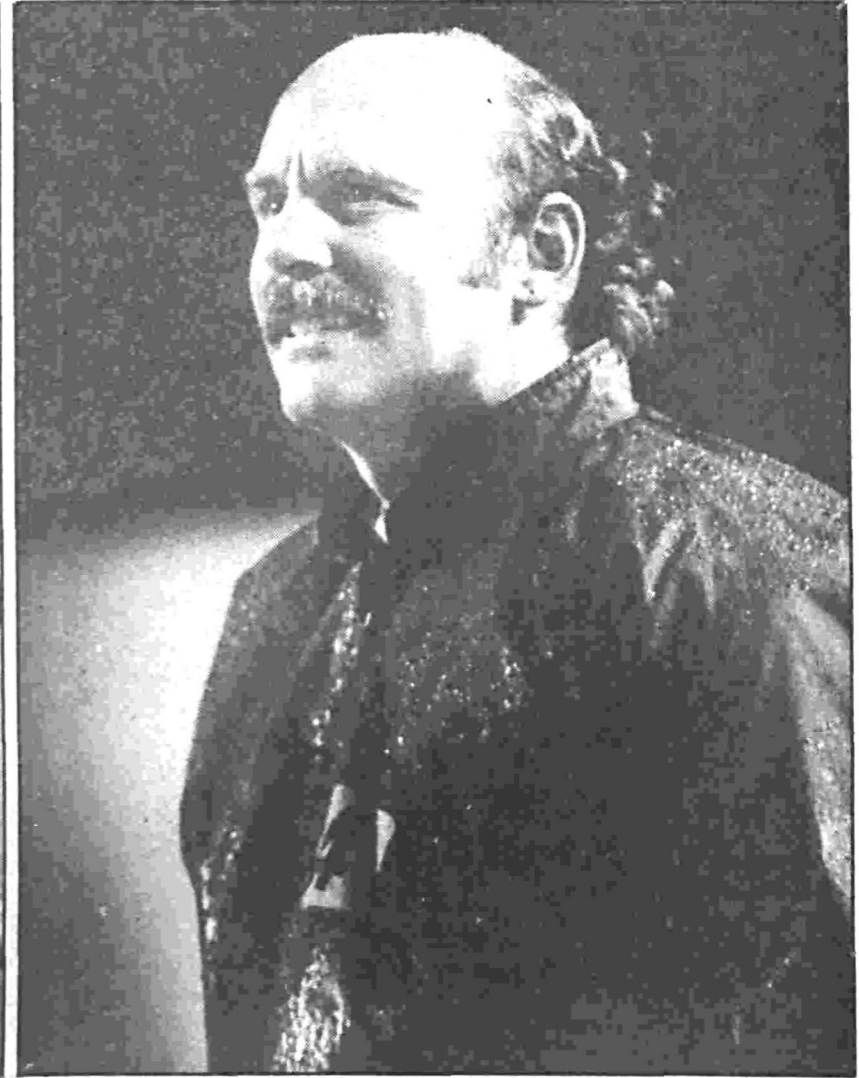

concerned when the Gators failed to turn CP mistakes into points as the Gators took a 14-7 loss. — photos by Roy Musitelli

# Gators miss chance to end loss streak

by Harry Brooks  
All of the elements that have kept the Decatur Gators winless this season — the turnovers, the missed assignments, the unenviable ability to give up the big play — combined with the rain Thursday night to dampen Decatur's Homecoming game. A usually explosive Clover Park attack, hampered by an outstanding Gator defensive effort, fizzled along throughout the contest and afforded Decatur numerous chances to break a loss streak that stood at 11 straight going into Thursday's contest. But Clover Park used two long, scoring passes in the second quarter and watched Decatur lose its composure in the second half while taking a 14-7 win. The visiting Warriors, leading 10-0, graciously bestowed field position to the Gators in the final two quarters. Decatur only cashed in on one Warrior favor when a punt-formation center snap zipper reach. Decatur's Phil Fox grabbed the bouncing ball on the run at

the CP 4 and continued into the end zone. Steve Babcock's successful extra-point kick cut Clover Park's lead to 14-7 with 2:40 left in the third quarter. BUT DECATUR failed to take advantage of three other Warrior gifts in CP territory during the second half. Senior tackle Scott Bohn gave Decatur possession on the Warrior side of the 50-yard line twice with fumble recoveries. His first find put Decatur at the CP 20 midway through the third quarter, but the Gators blew the opportunity via a center-quarterback exchange fumble which CP recovered at the 13. With 2:48 remaining in the game, Bohn pounced on a loose ball at the CP 36. Randy Moen ripped off an 11-yard run on the next play and followed with a two-yard dive to the 23. There problems struck quarterback Greg Andal. First, the sophomore signal caller dropped the center snap but recovered, and then he was bounced on successive sacks of nine and 10 yards. Clover Park

took possession after the second setback with 1:12 left to play and ticked the clock away with three inside running plays. DECATUR also received another shot at paydirt when Steve Babcock intercepted a Jim Cassidy pass at the CP 30, the threat ended when Babcock's 40-yard field goal attempt fell short. "We just broke down at critical times," Decatur coach Greg Flynn said. "We haven't been in positions like that very much this year, and I think our kids got a little too excited and lost their cool." The most discouraging moment for the Gator cause occurred early in the fourth quarter when Clover Park stopped a Decatur march, the only legitimate drive of the game, two feet from the Warrior end zone. The 58-yard, one-foot offensive began when Andal and Mike Perry combined for a 49-yard pass-run play to the CP 20. Veer blasts at the Warrior line moved Decatur to the 11, where Moen converted a fourth-and-one situa-

tion with a five-yard dash. Moen powered to the 3 on the next play, but his running mate Mike Hagen was held for no gain in the middle. Moen could manage just another yard on another dive play, brining up a fourth-and-two circumstance. Flynn elected to stay with the straight-forward theme, but Moen was stacked up 24 inches short of the goal line on a crash over right guard with 8:32 remaining on the game clock. "WHEN YOU have four plays from the five, you should be able to score," he muttered. "But I felt that even if we didn't we could force them to give us the ball back in good position with plenty of time left." The coach's outlook appeared correct as the Gator defense allowed the Warriors four yards in three plays. Alas, Clover Park aligned in punt formation on fourth-and-four, and Decatur lined up on offense. The penalty gave the Warriors a first down, and two plays later, Elton Edwards took off on a 35-yard run to the

Decatur 49. Missed assignments in the Decatur defensive backfield blemished an otherwise stellar performance by the Gator stop corps. Cassidy and tight end Pat Martin combined to provide the Warriors' scoring on two identical pass patterns. EARLY IN the second quarter, Cassidy made the most of a fourth-and-15 situation by hitting Martin, trotting all alone at the 10. After making the snag, Martin crossed the goal line at 10:37 of the second quarter. Four minutes later, Cassidy and Martin teamed on the same play, which was (n't) defended the same way, for a 66-yard TD. "We were really conscious of their running game, and they burned us with those play-action passes," Flynn said and explained why they worked so effectively. "They would fake the handoffs, and the receiver (Martin) would delay. Our halfback would charge to stop the run, and the receiver would go flying by. Actually, we've had problems being burned on long passes all year." Flynn and his Gators had good reason to be concerned with Clover Park's ground game. The speedy Warrior backfield features Chuck Dennis, possibly

the most dangerous running back in the SPSL. FLYNN used line slants and keyed his linebacks on Dennis, and the strategy allowed Clover Park just 88 rushing yards for the game. Dennis ended the contest with 16 yards on 21 carries. Moen and Hagen led a Decatur blitz that either stopped Dennis for no gain or threw him for losses 10 times. "Our defense did a nice job with our game plan," Flynn said, then pointed to the positive side of Thursday's play: "I'm glad our team is competitive with a team like Clover Park. All the kids are showing good character in the face of our record."

Clover Park 14, Decatur 7					
	1	2	3	4	T
Clover Park	0	14	0	0	14
Decatur	0	0	7	0	7

CP: Martin, 35 pass from Cassidy (Allen kick).  
CP: Martin, 66 pass from Cassidy (Allen kick).  
Decatur: Fox, 4 return of fumble (Babcock kick).

Team Stats		
	CP	Dec.
1st downs	7	10
Rushing yds.	88	96
Passes	4-9-1	2-7-2
Passing yds.	119	49
Total yds.	307	145
Fumbles-lost	4-2	7-2
Penalties-yds.	5-45	5-39

# Eagles run past Bethel, 30-0

by Harry Brooks  
The Federal Way Eagle offense woke from a six-game slumber Friday night and delighted a Homecoming crowd with 30 (thirty) points. Meanwhile, the Eagle defense had its usual outstanding performance, keeping the Bethel Braves scoreless and allowing just 75 total yards. Federal Way gave quarterback John DeRocher, who led the SPSL in passing last season, his worst statistical outing of his high school career. The junior QB managed only two completions in 14 passing attempts for 22 yards. In fact, Federal Way defenders had a

catching mark, five interceptions, better than that of the Bethel receivers, who snagged three. Rob Cables picked off two DeRocher aerials, and Dean Youngblood grabbed another, his sixth of the season. DuRocher's replacement, Marty Plumb, also fell victim to the Eagles' ball-hawking tactics. HIS THIRD pass, a floating screen to the left flat area, was snatched by Todd McGrady on the full run. Nothing stood between the senior fullback-linebacker and the goal line as he sprinted 23 yards for Federal Way's fourth and final touchdown. BUT STELLAR defensive play isn't anything new for Federal Way this season, being the major element in the Eagles' 5-3 record, third best in the SPSL. A consistent yard-churning offense, like that which went on exhibition Friday, was something unique for Federal Way this season. The Eagles rushed for 245 yards, highlighted by Todd McGrady's 109 on 12 carries (a nine-yard average per tote). Quarterback Butch Cratsenberg had touchdown runs of 31 and 25 yards while compiling a 66-yard

total on 15 carries. McGrady's TD run with an interception and an earlier score on a one-yard plunge gave him league-leading totals of 10 touchdowns and 60 points. "We needed this kind of a game for our self-confidence," a rejuvenated Federal Way coach Doug Adkins chirped as the rain pelted his new "lucky" hat. "We knew they couldn't run, so we put in a few new pass defenses for them. I think we had a pretty good plan." Federal Way will end its season Friday in a battle for the "District Championship" against the Jefferson Raiders, a 32-8 loser to Lakes last Friday, at Federal Way Stadium.

Federal Way is the host in the 8 p.m. contest. THE EAGLES found paydirt on their first possession last Friday when Cratsenberg ended a six-play, 60-yard drive with a nifty 31-yard run. The senior QB broke through right tackle, freed himself from a pile at the Bethel 25, cracked two tackle attempts while veering right and sprinting to the corner of the end zone with 5:29 left in the first quarter. Ten seconds before

halftime, McGrady dove through the left side of the Bethel line for a one-yard touchdown. The play capped a six-play, 34-yard march that was set up by Mike Bruner's punt block. Blaine Wilson kicked extra points after each first-half TD to give the Eagles a 14-0 edge at the break. Federal Way took first possession of the second half at the FW 30 and, less than three minutes later, racked up its third touchdown on Cratsenberg's 25-yard scamper. Again,

the stocky signal caller bounced tacklers while rounding right end, reversing direction against the flow and racing to the left flag. The scoring jaunt came on the sixth play of the drive, which included a 34-yard McGrady burst. Wilson's 27-yard field goal early in the fourth quarter and McGrady's interception-return score midway through the period closed the Eagle tally. (A descriptive photo of the contest is printed on pg. B2).

**SPSL Standings**

Team	W	L
Puyallup	5	0
Rogers	5	0
Federal Way	5	3
Bethel	4	4
Clover Park	4	4
Lakes	4	4
TJ	3	5
Sumner	3	5
Curtis	1	7
Decatur	0	8

Scores  
Federal Way 30, Bethel 0;  
Clover Park 14, Decatur 7;  
Lakes 32, Jefferson 8;  
Puyallup 33, Curtis 6; Rogers 22, Sumner 15 (OT).

FW 30, Bethel 0

	1	2	3	4	T
Bethel	0	0	0	0	0
FW	7	7	6	10	30

FW: Cratsenberg, 31 run (Wilson kick).  
FW: McGrady, 1 run (Wilson kick).  
FW: Cratsenberg, 25 run (kick failed).  
FW: Wilson, 25-yd. FG.  
FW: McGrady, 23 return of pass int.

Team Stats		
	B	FW
1st downs	4	15
Rushing-yds.	22-53	52-245
Passing	3-21-5	3-6-1
Total yds.	5	263
Fumbles-lost	2-1	4-2
Penalties-yds.	4-27	3-25

EARTH STOVES TIMBERLINE STOVES AND INSERTS COUNTRY INSERTS

## Sea-Tac Fireside Shop

Wood Stoves And Inserts

LIFETIME WARRANTY KODIAK STOVES AND INSERTS 24" LOG OPENING

3 LOCATIONS TO SERVE YOU

Federal Way 32700 Pacific Hwy. So. 838-0543 Mon. & Fri. 'til 8:30

Kent 23633 Benson Hwy. S.E. 854-7710

West Seattle West Seattle Fireside Shop 5040 California Ave. S.W. Seattle, 935-7069

OPEN MONDAYS THRU SATURDAYS 9 a.m.-6 p.m.

Federal Way News/Des Moines News

# YOU PICK 'EM

FOOTBALL FORECASTING CONTEST

SPONSORED THIS WEEK BY SCOTT'S ATHLETIC EQUIPMENT-839-2060 Winner Receives \$15.00 Gift Certificate

Mark an "X" in the box next to the team you think will win.

HOME TEAM	
<input type="checkbox"/> Sumner	<input type="checkbox"/> Decatur
<input type="checkbox"/> Jefferson	<input type="checkbox"/> Federal Way
<input type="checkbox"/> Mt. Rainer	<input type="checkbox"/> Evergreen
<input type="checkbox"/> Washington	<input type="checkbox"/> California
<input type="checkbox"/> Wash. State	<input type="checkbox"/> Oregon St.
<input type="checkbox"/> Arizona St.	<input type="checkbox"/> Stanford
<input type="checkbox"/> Nebraska	<input type="checkbox"/> Missouri
<input type="checkbox"/> N. Carolina	<input type="checkbox"/> Maryland
<input type="checkbox"/> Cincinnati	<input type="checkbox"/> Baltimore
<input type="checkbox"/> Los Angeles	<input type="checkbox"/> Seattle

TIE-BREAKER: Jefferson  WIN  LOSE by  POINTS

NAME \_\_\_\_\_ ADDRESS \_\_\_\_\_ PHONE \_\_\_\_\_

RULES: All entries must be mailed or delivered to Federal Way News office 1634 S. 312th, Federal Way, 98003, or Des Moines News, 22307 Marine View Drive, Des Moines, 98188, by 5 p.m. Thursday following this publication. Mail Entries must be postmarked on or before Thursday. Anyone can enter, but only once per week. Other late entries will not be accepted. Robinson Newspaper employees are not eligible (except paper carriers). Judges' decisions are final.



### Tugging on a sack

MIKE BRUNER (dark jersey) displays how Federal Way's defense treated Bethel quarterback John DuRocher during Federal Way's Homecoming game Friday. DuRocher, the SPSSL's leading passer last season, completed just two of 14 pass attempts and suffered three interceptions as Federal Way took a 30-0 win. — photo by Roy Musitelli

## Lakes, rain dampen Jefferson

by Dave Thomas  
The Thomas Jefferson Raiders, coming off two consecutive victories, entered their game against Lakes last Friday looking for their third. Unfortunately, the Raiders did not want to oblige the Raiders as they defeated their visitors 32-8 at Clover Park field in Tacoma.

A disappointed Jim Gard, TJ head coach, said his team just wasn't ready to play. "We gave too much momentum to them. Our tackling was really bad, and punt coverage broke down."

The Lancers put the game away in the first half scoring all four times they handled the ball. They got started on a 42-yard punt return to the Raiders 15-yard line by Ron Archie. It took them just five plays to complete the drive, capped off by a four yard run by Archie.

Next time Lakes got the ball they moved 62-yards in 13 plays. The drive was not a playbook one. The Lancers appeared to be losing ground as often as they gained it. Two big plays, however, and got as far as their own forty-five in the first half.

Second half action began with the rain starting to come down heavily. The first series for both teams showed the effects the rain had on ball handling. Lakes took the opening kick off at their own seven. One play later Schneider fumbled the ball and the Raiders recovered at the ten. However, two plays later Raider quarterback Jay Gard fumbled with the handoff to Mike Brogan and Lakes recovered at the ten.

Coach Gard felt that fumble was another turning point in the game. "If we could have gotten a quick

score there, then the complexion of the game might have been different."

For the rest of the third quarter the weather took control of the game. Neither team could mount a substantial drive and penalties and turnovers dominated the action.

Jefferson finally mounted a drive late in the final quarter. They marched 57-yards in nine plays for the score. The drive was led by the running of Dean DeMulling and passing of Jay Gard. With 3:37 left in the game Gard sneaked the ball over the goal line from two yards out for Jefferson's only score. They added the two-point first came on a third and long pass from quarterback Archie who carried the ball 20-yards for a first down. The second break was a third

down pass to Claude Dixon for 27-yards and a touchdown. The score came with just 12 seconds left in the first quarter and made it 14-0.

In the second quarter lakes continued where they left off, moving 7-yards in only seven plays. The big play in the drive was a 47-yard touchdown run by Mark Schneider. The extra point was missed, making the score 20-0.

Lakes was not finished just yet. They moved the ball to the Raiders thirty-seven with just under a minute left in the first half. Then, Lambert hit Bruce Forsland

with passes of 15 and 14 yards. With the ball on the seven, Lambert hit Dixon in the endzone for another score. The missed two-point conversion made it 26-0 at halftime.

Lakes 32, Jefferson 8		
TJ Lakes		
1st downs	6	17
Passing	4-12	5-11
Passing-yds.	23	88
Rushing-yds.	25-95	48-269
Total Offense	113	357
Fumbles-lost	3-1	4-2
Penalties-yds.	1-15	7-85

## HS golf scores

The Decatur Gators and the Bethel Braves ended the regular SPSSL golf season in a second-place tie after tying a match, 69-69, Monday at Twin Lakes. Both Decatur and Bethel finished the dual-match season with 9-3-1 records. Federal Way finished in a fourth-place deadlock with Clover Park with a 7-6 tally. The Eagles beat Clover Park 65-62 Monday but fell to league champ Lakes 78-66 Thursday. Jefferson came in with a 4-9 record after suffering a 39-31 loss to Curtis in the Raiders' Monday finale.

The three local teams will enter the medalist tournament tomorrow at Tumwater. Decatur has a strong chance of landing a state tournament berth, and Federal Way could be a surprise state qualifier.

## Gymnastics judging clinic at FW High

Ben McIrvine will head up a gymnastics judging clinic beginning this Tuesday from 7-9 p.m. in the Federal Way High School cafeteria. The clinic will also run on November 1, 6 and 8 from 7-9 p.m. Participants will be taught how to judge compulsory routines. For further information call McIrvine at 839-0523 or Bud Hately at 839-9192 or 927-6228.

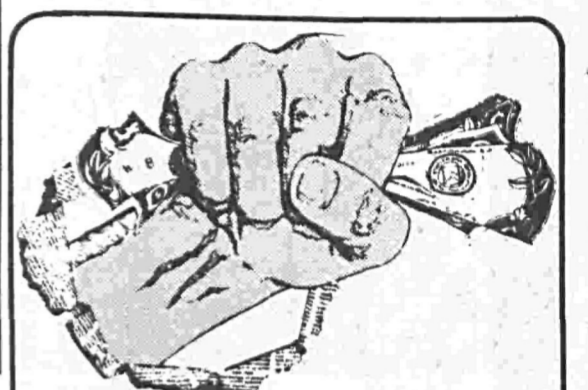

Would you like to \$ave?  
**PAY CASH SAVE CASH!**  
AT SEA-COMA LUMBER  
prices good thru OCT 30th

**PLYWOOD**  
**4x8x1/2" CDX**  
\$7.49 shop

4x8x3/8" T-I-II shop **7.95**  
4x8x5/8 T-I-II shop **11.49**

**4x8x1/2 Plasterboard**  
**\$3.49** u-haul

12.5 lb. joint compound **\$3.00** ea.  
reg. 3.65

62 lb. joint compound **\$8.35** ea.  
reg. 9.25

### BRONZE INSULATED WINDOWS

6°x3°	<b>53<sup>60</sup></b>	6°x4°	<b>56<sup>25</sup></b>
3°x	<b>34<sup>69</sup></b>	4°x5°	<b>59<sup>35</sup></b>

Many other sizes in stock

### LUMBER

**2x4 2 & BTR GRN**  
10' - 20' ..... **20¢** lf.

**2x6 2 & BTR GRN**  
10' x 20' ..... **30¢** lf.

**2x4 2 & BTR**  
8' ..... **1.50** ea.

**2x4 STUD**  
88 5/8 ..... **99¢** ea.

### JER STORAGE SHEDS

**ALL WOOD**  
8x8 & larger models on display  
from **\$239<sup>95</sup>**

Special limited to stock on hand. CASH and CARRY with delivery available. **BANKCARDS WELCOME.**

**SEA-COMA LUMBER**  
34211 Pac. Hwy. So. Fed. Way

PHONES SEATTLE 838-4700  
TACOMA 927-8304  
M-F 8-5:30  
SAT 8-4

**QUANTITY DISCOUNTS ON BUILDING MATERIALS PHONE & COMPARE**

SUNDAY WE RESERVE FOR OUR FAMILIES.

**BELKNAP GUTTER SERVICE**  
CONTINUOUS ALUMINUM GUTTERS  
• BIG 5-INCH GUTTER  
• FHA-APPROVED  
• BAKED-ON ENAMEL

PER FT. (ONE-STORY) **\$1.09** a foot  
FOR FREE ESTIMATE CALL **927-4392**

**SPECIAL SALE**  
Rebuilt Auto Transmissions  
**\$185. - \$285.**  
Includes Converter (if needed)

**Transmission Tune-Up**  
**\$24.95**

INCLUDES LABOR REPLACE FLUID, FILTER PAN GASKET, AND ADJUST BANDS

**E.A.R. TRANSMISSION AND PARTS**  
1626 S. 341st. Pl.  
838-2740

Expires 11/30/79 Value 1/20\*

# Carpet I

It's our **BIGGEST** and **LAST** Storewide **SALE** this year!

CARPETS **4<sup>95</sup>** sq.yd. and up

CHOOSE FROM A LARGE SELECTION

**ALL REMNANTS MUST BE SOLD**

**NO REASONABLE OFFER REFUSED!**

...PLUS...HUGE SAVINGS ON **CARPET CLEANING!**



We are featuring...

*Trans Black*  
fine carpet fashions by Armstrong

OVER 3200 SQ. FT. OF SHOWROOM DISPLAYS TO SERVE YOU.



5123 No. Meridian (EDGEWOOD) PUYALLUP

Seattle Tacoma 839-7448 927-0310

Mon, Tues, Wed 9-6  
Thurs, Fri. 9-8  
Sat 10-6 Sun 12-4

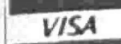

Tri-Cities 946-6556

# TAKE OFF

FOR YOUR NEAREST SCHUCK'S

# PRE-CHRISTMAS

# LAYAWAY SALE!

**ALL BIKES SET UP FREE**

ALL SCHUCK'S BIKES ARE MADE AND ASSEMBLED TO THE DEMANDING SPECIFICATIONS OF THE FEDERAL GOVERNMENT SAFETY REGULATIONS



NEW... SX SERIES MOTOCROSS MAG WHEELS!

SCHUCK'S PT SX250

- OCTOPUS HAND GRIPS • PADDED BAR AND STEM • EXTENDED HARD-TAIL FRAME • 20 x 2.125 STAGGER BLOCK TIRES • HI-TORQUE CRANK • RACELINE OF L.A. FORK

**124<sup>99</sup>** REG. 144.99

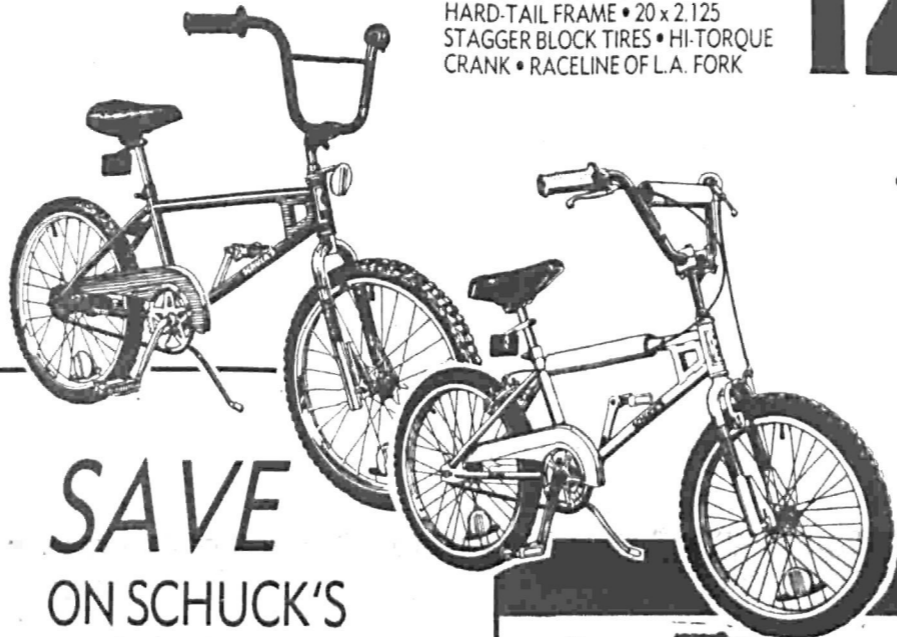

SCHUCK'S PT SX-125

- HARD-TAIL EXTENDED FRAME • RACELINE OF L.A. FORK • HI-TORQUE CRANK

REG. 89.99

**74<sup>99</sup>**

SCHUCK'S PT SX-175

- OCTOPUS GRIPS • PADDED BAR AND STEM • HARD TAIL FRAME • STAGGER BLOCK TIRES • RACELINE FORK

REG. 99.99

**84<sup>99</sup>**

SCHUCK'S PT SX-400 THE ULTIMATE!

- CALIPER BRAKES • DOUBLE GUSSET FRAME • RACELINE FORK • REAR FREE WHEEL • TOP BAR AND HANDLE BAR PAD • STAGGERBLOCK TIRES • ALLOY RIMS/HANDLEBARS • 6 1/2" COTTERLESS CRANKS

REG. 199.99

**169<sup>99</sup>**

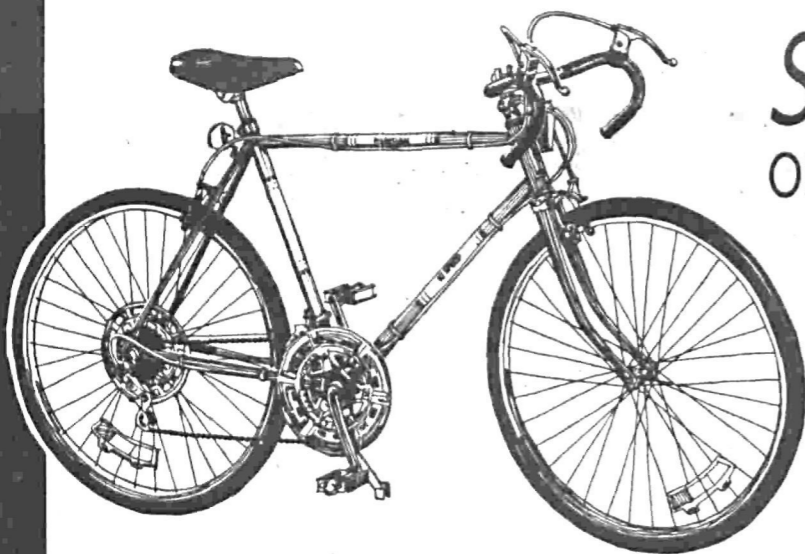

SAVE ON SCHUCK'S 3 ALL TIME FAVORITES!

YOUR CHOICE

REG. 109.99

**93<sup>99</sup>**

PT 10-SPEED **PARISIAN** 26" OUR MOST POPULAR 10-SPEED, MANY DELUXE FEATURES!

PT 3-SPEED **KINGSTON** 26" FOR MEN OR WOMEN. FRONT REAR CALIPER BRAKES, FENDERS!

PT 10-SPEED **OLYMPIAN** 24" JUST THE RIGHT SIZE FOR YOUNG GUY OR PETITE WOMAN



SCHUCK'S POPULAR ENDUROS

20" PT ENDURO 6

- MOTOCROSS STYLING • OFFICIAL NUMBERS • REFLECTORS

REG. 79.99

**69<sup>99</sup>**

PT ENDURO 7

- PERFECT GIRL'S MOTOCROSS BIKE

REG. 93.99

**79<sup>99</sup>**

PT ENDURO 9

- ULTIMATE ENDURO FOR BOYS!

REG. 93.99

**79<sup>99</sup>**

PT ENDURO 8

- OUR BEST ENDURO!

REG. 103.99

**87<sup>99</sup>**

PT MINI ENDURO 4

- FOR SMALL FRY

REG. 62.99

**54<sup>99</sup>**



SCHUCK'S PT POWDER PUFF

- HIGHRISE FOR GIRLS. BUILT TO TAKE IT BUT FEMINE

**69<sup>99</sup>** REG. 79.99



SCHUCK'S PT 26" 10-SPEED MONTE CARLO

- DELUXE MODEL WITH MANY QUALITY FEATURES

**104<sup>99</sup>** REG. 126.99



SCHUCK'S PT 27" 10-SPEED GRENOBLE

- A BEAUTIFUL RACER IN GLEAMING WHITE FINISH

**114<sup>99</sup>** REG. 137.99

## BICYCLE ACCESSORIES ON SALE, TOO!

COMB. LOCK WITH 4' CABLE  
REG. 6.99  
**4<sup>99</sup>** REG. 7.49  
STEEL PADLOCK OR COMB. LOCK REG. TO 2.79

TRAINING WHEELS  
GETS 'EM STARTED!  
REG. 6.49  
**4<sup>99</sup>**

LIGHT and GENERATOR SET  
RECT. CHROME HEADLIGHT TAIL LIGHT  
REG. 9.99  
12 V. GENERATOR SET W/TAIL  
REG. 10.99  
**7<sup>99</sup>** REG. 8.99

SPEEDOMETER FOR 20", 26", 27" BIKES  
MILES & KILOMETERS ODOMETER UP TO 9,999 MILES  
REG. 12.99  
**9<sup>99</sup>**



# SCHUCK'S AUTO SUPPLY

45 STORES IN THE NORTHWEST TO SERVE YOU

© 1979

HOURS: Monday thru Friday 9 AM to 9 PM Sat. 9 AM to 6 PM Sunday 10 AM to 6 PM • PRICES GOOD THRU SUNDAY

FEDERAL WAY  
31430 PACIFIC HIWAY SO.  
941-2700

BURIEN  
130 S.W. 152nd  
CH 3-1133

SOUTHCENTER  
1033 SOUTHCENTER  
CH 6-6595

# Mt. Rainier grabs first grid win

by Brien Lautman

The pouring rains gushed down upon Highline Stadium last Friday night, but the precipitation that has drenched the Mt. Rainier Rams parade throughout the current North Puget Sound League grid season has ended. The Rams broke into the win column by virtue of a 13-6 heartstopper over the Auburn Trojans.

For the Rams it was simply delicious after a frustrating seven straight setbacks that nailed them firmly into the NPSL cellar. Seniors cried, coaches hugged each other, while unsuspecting sophomore smiled quietly, grasping the feel of a winner.

"Lock on to this feeling fellas and remember this feeling as long as you can," Head Coach Jerry Dotson said in the emotion-swept Rainier lockerroom. "We played as a team tonight and won. There will be many more to come too," he shouted, "many more."

But the Ram players would not let Dotson pass this initial win on to themselves; instead they praised their coach as a firm

believer in their program. "We couldn't have done it without Coach Dotson," several players yelled. "We played this one for him. We wanted it for him," Assistant Coach Bob Kelly said.

The Rams, however, began their search for win number one last Friday with a familiar look. On first and ten from their own 25-yard line, Bob Forsloff threw over the middle for Pruitt, but the pass ended up in the hands of Auburn's Mike Amburgey, and the Trojans found themselves with a first down at the Rainier thirty.

Auburn displayed a patient, up the middle offense from there as Jeff Schulz picked up 17-yards on four carries to push the ball to the Ram eight. Schulz then cracked over left guard the remaining distance, putting the visitors in control at 6-0. Time Haywood missed the point after attempt.

Auburn then tightened up on the struggling Mt. Rainier offense, yielding just eight first quarter yards to their hosts. The Trojan defense gave up just 21 yards rushing all evening to the Rainier offense, while it was a

turnover-plagued offense that spelled defeat for Auburn.

While on their own 18-yard line late in the second quarter, Trojan signal-caller Cal Karbowski threw for intended receiver Brian Swift, but Larry Pruitt stepped in to pick off the aerial and carry it to the Auburn twenty-two. Following a clipping penalty that moved the ball back to the forty-three, Dotson sent ailing quarterback Craig Maley in to replace Forsloff. Maley responded by throwing a 43-yard scoring pass to Pruitt, who slipped behind defender Mark Haughn for the equalizing points. Ty Beach, however, could not break the deadlock as he failed on the point after sending both teams in at intermission deadlocked 6-6.

Following Maley's scoring

pass, the Rainier offense was not to surface again. The Ram's simply let the defense take care of the scoring.

Heading up that assignment was senior captain Val Blevins who blasted in from the right side of the Trojan line on the visitors initial second half possession, to block Doug Varphotz's punt. Blevins then scooped the rolling pigskin up and rambled 18-yards to paydirt, giving the Rams a fragile 12-6 lead. Beach upped that total to thirteen with the PAT.

An alert Rainier defense was responsible for protecting the precious lead as they continued to come up with Trojan fumbles at key intervals, and tough goal line defense. The Ram stop squad squelched

an Auburn mid-fourth quarter surge for the goal line with solid pass defense as Karbowski, following a Trojan drive that began on their own thirty-eight, and ended on the MR four, continued to throw into the endzone, but with no luck. Karbowski did connect on fourth and goal with Amburgey, but the officials ruled the big tight-end did not plant his feet inside the endzone. But the Rams were not out of the fire yet, as they took over on their own four with 2:37 remaining to play. Auburn quickly forced the punchless Rainier offense into a punting situation where Mike Martini booted it out to the thirty-five.

Again, Karbowski began to flail away at the Rainier secondary with less than a minute remaining in the game. But Karbowski,

who threw for 81 yards on the evening, could find only Mt. Rainier defensive back Kelly Johnson, who clutched the interception, insuring the Ram victory.

Mt. Rainier	13	Auburn	6
Aub	1	2	3
MR	0	0	0
MR	0	6	7
Auburn: Jeff Schulz	8	run	(kick failed).
Mt. Rainier: Larry Pruitt	43	pass	from Craig Maley (kick failed).
Mt. Rainier: Val Blevins	18	blocked punt	return (Ty Beach kick). Team stats
	Aub	MR	
1st downs	17	4	
Rushing-yds.	5-166	19-21	
Passing	6-18-3	1-4-1	
Pass yds.	81	39	
Fumbles-lost	7-3	2-0	

## MR spikes Lancers, stopped by Royals

by Brien Lautman

The Mt. Rainier Ram girls' volleyball team continued its winning ways last Thursday night as they stormed passed the Kennedy Lancers 15-0, 13-15, and 15-9. The win, coupled with a Tuesday 15-5, 15-1 loss to Kent-Meridian put the Rams at 3-5 on the season.

Rainier got off to a lightening-quick start against the Lancer girls, clawing to a 15-0 shutout win. The whitewash of their visitors caught Ram Coach Neil Hutchison completely off-guard, but nonetheless pleased.

"It's incredible. I think that's the first shutout by anyone this

season. The girls just jammed the ball right down their throats."

Hutchison cited good steady serving and strong net play, in particular Jelene Barton's conscientious front line play.

The Rams encountered some let-down in the following game, however, dropping it 15-13, and setting up a deciding third game.

"We just lost our edge and our concentration," Hutchison said. His girls managed to regain their winning frame of mind for the final game as they stroked to a 15-9 win behind the spiking of Pam Gossman and Denise Hendricks.

Lori Wellman and

Allison Huber added to the Rainier effort with pinpoint serving and "good all-around play."

The Des Moines club found life away from home a bit rockier on Tuesday afternoon as the powerhouse Kent-Meridian Royals turned the Rams every way but loose.

The Rams lost 15 points in the two afternoon matches on serving alone. "It's not that our kids were choking, but Kent-Meridian just served extremely well," Hutchison said. "Nobody will touch them this year. Their jayvees could be the number two team in the state."

## Avon sponsors Seattle Tennis

Campbell Sports, Inc. and Old National Bank will present the 1980 \$150,000 AVON Tennis Championships of Seattle.

According to Michael Campbell, president of Campbell Sports, Inc., his firm has been involved in producing professional women's tennis tournaments in Seattle since the first one was held in 1977.

The history of the tournament demonstrates the high quality of tennis action Seattle fans have become accustomed to enjoying. The 1979 final brought Chris Evert Lloyd her second Seattle championship, a 6-1, 3-6, 6-3 victory over Renee Richards.

This marks the second year of involvement for Old National Bank. The bank will again serve as the presenting sponsor for

## AVAILABLE SEPT. 1

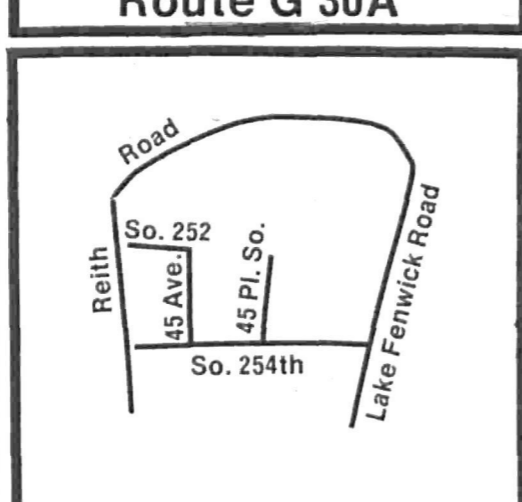
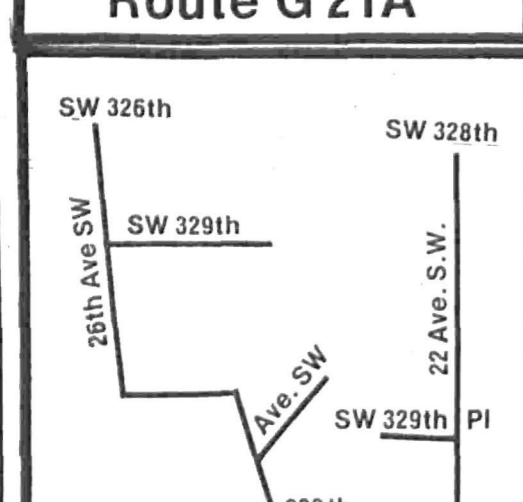
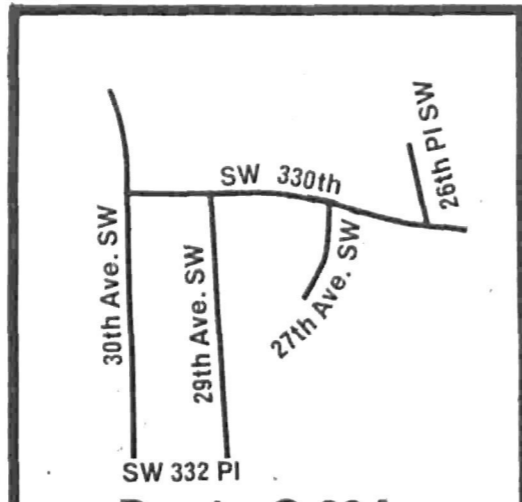
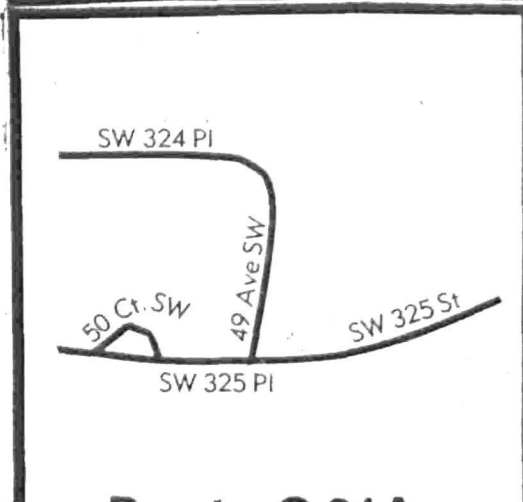
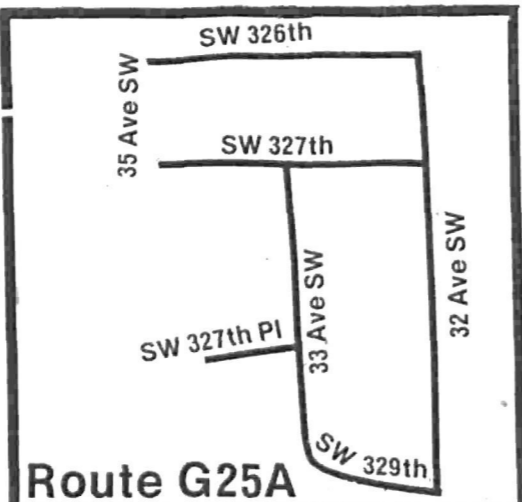
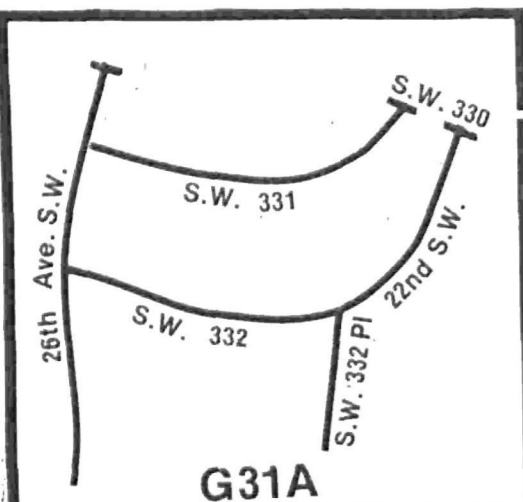

These Federal Way News Carrier Routes ARE AVAILABLE NOW.

For more information, call Circulation: **941-4400**

## GOOD YEAR ELIMINATE WINTER TIRE CHANGEOVER

The Original All Season Radial... **TIEMPO \$41.95**

SIZES FOR U.S. CARS				SIZES FOR IMPORT CARS			
Metric Size Whitewall	Fits	EVERY DAY PRICE	Plus FET and old tire	Metric Size Whitewall	EVERY DAY PRICE	Plus FET and old tire	# of.
P185/75R13	BR78-13	\$53.00	\$2.00	P155/80R13	\$41.95	\$1.59	
P195/75R14	ER78-14	\$70.00	\$2.30	P165/75R13	\$49.25	\$1.65	
P205/75R14	FR78-14	\$76.00	\$2.50	P165/80R14	\$51.50	\$1.72	
P215/75R14	GR78-14	\$79.25	\$2.60	P155/80R15	\$51.50	\$1.71	
P225/75R14	HR78-14	\$84.50	\$2.80	P165/80R15	\$53.00	\$2.00	
P205/75R15	FR78-15	\$78.00	\$2.61				
P215/75R15	HR78-15	\$81.00	\$2.79				
P225/75R15	LR78-15	\$87.75	\$2.95				
P235/75R15	LR78-15	\$94.00	\$3.09				

**Lube & Oil Change \$6.88** Includes up to five quarts major brand 15W/40 oil. \$39.95 car wash. Includes tire rotation.

**Front-End Alignment and FREE tire rotation \$17.88** Parts and additional services extra. Front wheel drive and steering included.

**Engine Tune-Up \$46.88** Includes listed parts and labor - no extra charge for air conditioner. Includes electronic ignition.

**GOOD YEAR TIRE CENTER**  
INDEPENDENTLY OWNED AND OPERATED BY SEATAC TIRE CO INC. OPEN: M-F 8:30-5:30 SAT 8-3  
**31629 PAC HWY SO 839-7730 or 927-4578**

**Kmart THE SAVING PLACE**

**'KMS 50' POLYESTER CORD MUD/SNOW BLACKWALLS**

Our Reg. 20.88 A 78x13 **17.88**

Plus F.E.T. 1.68 Each. All Tires Plus F.E.T. Each

SIZES	REG.	SALE	F.E.T.
C78x13	27.88	21.88	1.98
C78x14	29.88	23.88	1.97
E78x14	30.88	25.88	2.29
F78x14	32.88	26.88	2.42
G78x14	34.88	28.88	2.56
G78x15	36.88	30.88	2.62
560x15	30.88	23.88	1.82

**MOUNTING INCLUDED • NO TRADE-IN REQUIRED**

**"THE SEASON RADIAL" WINTER/SUMMER TREAD DESIGN**

Our Reg. 48.88-BR78x13 **35.88** Plus F.E.T. 2.11 Each

SIZES	REG.	SALE	F.E.T.
ER78x14	59.88	43.88	2.34
FR78x14	63.88	49.88	2.59
FR78x15	68.88	49.88	2.69
GR78x14	65.88	53.88	2.69
GR78x15	70.88	53.88	2.74
HR78x15	75.88	58.88	3.16
LR78x15	79.88	62.88	3.17

All Tires Plus F.E.T. Each

**auto service**

**SERVICES INCLUDE:**

- Oil change (Up to 5 qt. straight weight bulk Pennzoil motor oil)
- Install 1 K mart Brand Oil Filter\*
- Chassis lubrication (Fittings extra)
- Brake fluid (if needed)
- Gear Lube (if needed)

**OIL, LUBE, FILTER Sale Price - 4 Days**

Labor included. Additional parts, services extra. Save at Kmart. \*Single stage filters for most cars. **6.88**

**INSTALLED**

**CORROSION TREATMENT 96°**

**Kmart 6/72 BATTERY Sale Price**

Maintenance free! For many cars and light trucks. **58.88**

**FRONT DISC BRAKES Sale Price - 4 Days**

Work done on front end only for many U.S. cars. Save at K mart. **48.88**

Additional parts and services, which may be needed, are at extra cost. 1/2 & 3/4 ton P.U. higher.

PLEASE CALL FOR SERVICE APPOINTMENT

KEST 832-9821	BELLEVUE 746-9413	RENTON 229-4212	BRIARWOOD 327-4464	FEDERAL WAY 841-1732	EVERETT 353-8728	TACOMA 8th Ave 752-9828	EDMUNDS 714-5682	AURORA 383-2194
			LAKEMOOR 342-3457	LACEY OLYMPIA 458-6700	TACOMA 72nd 531-2899	WEST SEATTLE 787-7328	BELLEVUE 734-9085	PUYALLUP 848-9111



# REAL ESTATE NORTHWEST

FEATURING: HOMES, CONDOMINIUMS, COMMERCIAL INVESTMENTS, INDUSTRIAL SITES, RECREATIONAL PROPERTY, WATERFRONT, FARMS & ACREAGE, REAL ESTATE TRADES, BUSINESS OPPORTUNITIES, REAL ESTATE LOANS & MORTGAGES, INSURANCE, COMMERCIAL & RESIDENTIAL BUILDERS

## Open Houses

- The \* means more information is included in the company's ad in this section. This feature is offered by the brokers and sellers to give you, the reader, a guide to open houses available for your inspection.
- |   |  |  |
|---|--|--|
| 30805 13th Pl. S.<br>No. 25<br>Sunday 2-5<br>Coldwell Banker      | 31310 36th Ave. S.W.<br>Sunday 1-4<br>John L. Scott  | 3220 So. 291st St.<br>Sunday 2-5<br>Rhodes Realty                |
| 313 S. 210th St.<br>Sunday 1-5<br>Unruh Rlty.                     | 1410 S.W. 148rd St.<br>Sunday 1-4<br>John L. Scott   | 205 Milton Way-Milton<br>Sunday 1-4:30<br>B and M Rlty.          |
| 30004 Fifth Ave. S.W.<br>Sunday 1-5<br>Red Carpet<br>Sea-Tac Mall | 20520 Island Park Way<br>Sunday 1-4<br>John L. Scott | 34414 28th Pl. S.W.<br>Sunday 1-5<br>By Owner                    |
| 2403 S.W. 317th St.<br>Sunday 1-5<br>Benton-McCarthy Rlty.        | 16825 150th Pl. S.E.<br>Sunday 1-4<br>John L. Scott  | 11287 Marine View Dr. S.W.<br>Sunday 2-5<br>West & Wheeler       |
| 132 S.W. 308th St.<br>Sunday 2-5<br>Marine View Prop.             | 3021 15th St. N.E.<br>Sunday 1-4<br>John L. Scott    | 17961 Marine View Dr. S.W.<br>Sunday 2-5<br>West & Wheeler       |
| 1618 S.W. 164th St.<br>Sunday 2-5<br>Marine View Prop.            | 2325 W. 292nd St.<br>Sunday 1-4<br>John L. Scott     | 21434 13th Ave. S.<br>Sunday 1-5<br>John Hale Rlty.              |
| 633 S.W. 175th St.<br>Sunday 2-5<br>Marine View Prop.             | 225 S. 124th St.<br>Sunday 1-4<br>John L. Scott      | 30453 10th S.<br>Sunday 1-5<br>John Hale Rlty.                   |
| 11821 13th S.W.<br>Sunday 2-5<br>Marine View Prop.                | 4145 S.W. 314th St.<br>Sunday 1-4<br>John L. Scott   | Centennial Park-N.E. Tacoma<br>Sunday 1-5<br>Evergreen Rlty.     |
| 28104 10th S.<br>Sunday 2-5<br>Marine View Prop.                  | 29815 10th S.W.<br>Sunday 1-4<br>John L. Scott       | 27828 10th Ave. S.<br>Sunday 1-5<br>Evergreen Rlty.              |
| 18225 Eighth S.W.<br>Sunday 2-5<br>Marine View Prop.              | 25214 17th S.<br>Sunday 1-4<br>John L. Scott         | 32736 33rd Ave. S.W.<br>Sunday 1-5<br>Evergreen Rlty.            |
| 30412 11th Ave. S.<br>Sunday noon-4<br>Century 21-Young Homes     | 30655 First Pl. S.<br>Sunday 1-4<br>John L. Scott    | 805 S. 309th Pl.<br>Sunday 1-5<br>Evergreen Rlty.                |
| 29231 61st Ave. S.<br>Sunday noon-dusk<br>Century 21-Young Homes  | 1405 S.W. 298th St.<br>Sunday 1-4<br>John L. Scott   | 31343 31st Ave. S.W.<br>Sunday 1-5<br>Evergreen Rlty.            |
| 29225 61st Ave. S.<br>Sunday noon-dusk<br>Century 21-Young Homes  | 3605 S.W. Olga<br>Sunday 1-4<br>John L. Scott        | 5140 Beverly Dr.<br>N.E. Tacoma<br>Sunday 1-5<br>Evergreen Rlty. |
| 29303 61st Ave. S.<br>Sunday noon-dusk<br>Century 21-Young Homes  | 5118 S.W. Waite<br>Sunday 1-4<br>John L. Scott       | 4701 41st St.<br>N.E. Tacoma<br>Sunday 1-5<br>Evergreen Rlty.    |
| 29234 61st Ave. S.<br>Sunday noon-dusk<br>Century 21-Young Homes  | 3118 S.W. Orchard<br>Sunday 1-4<br>John L. Scott     | 16736 32nd Ave. S.W.<br>Sunday 2-5<br>Coldwell Banker            |
| 29302 61st Ave. S.<br>Sunday noon-dusk<br>Century 21-Young Homes  | 4108 C.S. 158th St.<br>Sunday 1-4<br>John L. Scott   | 23400 124th Ave. S.W.<br>Sunday 2-5<br>Coldwell Banker           |
| 29308 61st Ave. S.<br>Sunday noon-dusk<br>Century 21-Young Homes  | 530 S.W. 168th Pl.<br>Sunday 1-4<br>John L. Scott    | 30303 31st Ave. S.W.<br>Sunday 2-5<br>Coldwell Banker            |
| 44th Ave. N.E. and 33rd N.E.<br>Sunday 1-4<br>Viking Const.       | 15238 22nd S.W.<br>Sunday 1-4<br>John L. Scott       | 4206 S.W. 325th St.<br>Sunday 2-5<br>Coldwell Banker             |
| 29735 Third Ave. S.<br>Sunday 1-4<br>Dantelson Rlty.              | 26421 Somerset Lane<br>Sunday 1-4<br>John L. Scott   | 1810 Copalis<br>Sunday 2-5<br>Coldwell Banker                    |
| 37323 34th Ave. So.<br>Sunday 2-5<br>Rhodes Realty                | 11900 28th Ave. S.W.<br>Sunday 1-4<br>John L. Scott  | 51821 32nd Pl. S.W.<br>Sunday 2-5<br>Coldwell Banker             |
| 28761 11th Ave. So.<br>Sunday 2-5<br>Rhodes Realty                | 20507 93rd St. E.<br>Sunday 1-4<br>Rhodes Realty     |  |

### REAL ESTATE TIRED OF 50/50 SPLIT?

It's no fun splitting 50% of 50% is it? At Wallace & Wheeler, we pride ourselves on an in-house inventory second to no one. As a Wallace & Wheeler sales agent, you will reap rewards beyond commissions, like Hawaii trips and the Gold Triangle Club.

If you're a novice we will provide, at our expense, 30 hours of real estate training to prepare you for your career. For the experienced and successful, we will supply the tools to make 50/50 a thing of the past.

Wallace & Wheeler has recently expanded its south end marketing area to booming Burien with astounding success. Now is the time for you to join the winning team. For the cure to the 50/50 blues, call Randy Beck at 248-0664.

**WALLACE & WHEELER, INC.**

401 S.W. 153rd  
248-0664

## RHODES REALTY INC.

30900 Pacific Hwy. So. Federal Way, Wa. 98003  
Rhodes Professional Plaza Building  
941-3800 or 927-5020

### STately COLONIAL \$91,000

Traditional 5 bdrn two story colonial on shy acre. Stately columns enhance the entry to this stunning home featuring open stairway, 3 bathrooms, family room up with a rec-room down. Call 941-3800 on ad #455.

### \* ALL TERMS \$72,950

Lovely Bi-level home offering 5 bedrms, two full baths in one of Federal Ways nicest areas. Family home features storm windows throughout, lovely built in kitchen nook, family room & two fireplaces. Call 941-3800 today on ad #448.

### BURien SPECIAL!! \$59,950

Spotless 3 bdrn rambler with a beautiful private back yard. Features 1 1/2 baths, lovely fireplace, large family room & detached garage. This immaculate home includes stove, refrigerator & dishwasher. Call 941-3800 on ad #447.

### \* MARINE HILLS \$149,950

Super sound view from this beautiful 4 bdrn home. Quality built with 1 1/2 baths up, built-in vacuum system, intercom, two fireplaces, huge rec-room and full length deck. Call 941-3800 on ad #440.

### NEW CONSTRUCTION \$49,950

Brand new 3 bdrn rambler in quiet country setting. Features double wall construction, lovely fireplace & patio. Call 941-3800 on ad #A.

### REDUCED \$5,000 \$74,500

Beautiful two story home on large corner lot. Exceptional family home featuring 4 bedrms, pool table size rec-room, & two fireplaces. Park-like backyard with Patio & fruit trees. Call 941-3800 on ad #439.

### FAMILY HOME \$82,500

Huge, immaculate 4 bdrn mid-entry home. Prestigious living is found in this lovely home close to Park & Schools, featuring 3 baths, new carpets, two beautiful fireplaces, rec-room & double car garage. All of this plus a fenced yard & towering fir trees. Call 941-3800 on ad #420.

### B&M REALTY INVESTOR'S DREAM

What a duo! Lovely 2 bedroom home, backed by equally charming 2 bedroom mobile home. Large site with room for possible future improvements. Top condition, zoned general, priced right at \$104,950. OTHER INVESTMENT OPPORTUNITY FROM \$38,950. WE CAN HELP ARRANGE FINANCING ON ALL OUR HOMES! 838-4170 927-6028

## SUNRISE RIDGE

FROM \$59,500  
LARGE LOTS-SPLITS TRI'S - RAMBLERS

### OPEN HOUSE

SAT. & SUN. 1-6 p.m.  
QUALITY BUILT BY VIKING CONSTRUCTION  
952-4468 - 564-3312

### BARGAIN DAY

3 Bedroom split entry, 1 1/2 baths, family room, cozy fireplace in living room, deck off D/R looks onto pasture lands, dbl. car garage finished & insulated, all appliances, ready to move in low down VA/FHA \$57,500 MLS 53200-PY. Ask for Curt Peterson.

## PULTE

Master Builders® PRESENTS

### TWIN LAKES DIVISION X

SOUND VIEW HOMES STARTING AT \$84,975

## 9%

ANNUAL PERCENTAGE RATE

VA TERMS ALSO AVAILABLE  
BUILDER PAYS CLOSING COSTS

FOR DETAILS  
**941-6400**  
ASK ABOUT OUR GUARANTEED SALE OF YOUR PRESENT HOME.

### OPEN DAILY NOON TIL DUSK

DIRECTIONS: I-5 to So. 320th Exit. West on 320th to end. Left on Hoyt Rd. to S.W. 326th, turn left and follow signs.

BENTON-McCARTHY REALTY, INC. Better Homes and Gardens

### WATERFRONT - PRICE REDUCED

4 bdrms., 2 car gar., frplcs., formal dining, landscaped, deck and patio, \$79,500.

### NEW CONSTRUCTION

Tri Levels, Splits, Ramblers to choose from - Lake Tapps, Sumner, Buckley areas.

### BEAUTIFUL COLONIAL

5 bdrms., 2 baths, 2 frplcs, 2 car gar., lg. wooded lot, Only \$79,950.

### SUMNER - ORTING AREA 29 ACRES - \$57,000

Partially wooded, good drainage, \$26,000 down and assume at 9 1/2%. GREAT INVESTMENT!

## ALL SEASONS REALTY INC.

2301 Main Street 863-2251  
Sumner, Wa. 98390 Seattle 682-9873

**YOUR FULL SERVICE REALTOR**

### LOOKING FOR A SUPER DEAL?

Federal Way News  
Des Moines News  
Highline Times

Look in classified

### Sherwood & Roberts Inc

Sherwood & Roberts proudly introduces DICK GODDARD as the new manager of the Federal Way Office. Dick has lived in the Federal Way area for 10 years with his wife Donna and 2 children. He has 9 years of Real Estate experience, including the last 6 years as manager and broker. He brings with him the professional knowledge and experience that typifies Sherwood & Roberts. Welcome aboard Dick!

Sherwood & Roberts also proudly announces the opening of their brand new office at 2020 S 320th, Suite D, opposite the Sea-Tac Mall. Please accept this invitation to stop in for a cup of coffee and a visit.

Sherwood & Roberts is the largest full-service Real Estate Company in the Northwest, with the capabilities to finance the land purchase, construction, mortgage processing, mortgage loan and refinancing of today's housing needs. If you are considering a real estate career, join a winning team. Drop in or call your local office today.

## Sherwood & Roberts Inc

Federal Way 2020 S. 320th Suite D Dick 941-3600  
Burien 630 SW 153rd Margo 244-3201  
Auburn 1440 Harvey Rd Nilah 939-4800  
Kent 310 N Central Suite A Pam 854-5000

## WEST & WHEELER ASSOC., INC.

### OPEN HOUSE 2-5 WATERFRONT ARBOR HEIGHTS 11287 Marine View Drive S.W.

Excellent contract terms - or assumption - available! Beautiful 3 bdrn, 3 bath Mediterranean style home with 180° Sound & Olympic view. - Plus 60 ft. sandy beach below. Double gates to estate-like setting. Appraised & offered for \$171,000! Be sure to see today with BETTY ANDERSON or call her at 244-5900, evens. 824-2244.

### FANTASTIC CONTRACT TERMS! NORMANDY PARK \$129,500 17961 Marine View Drive S.W.

Executive rambler on choice landscaped lot with lots of parking. Walk to Normandy Pk. Comm. beach. This lovely home features 3 bdrn, 2 1/2 baths, family room, formal dining & spacious kitchen w/eating space. Terms are: you pay \$35,000 down, assume \$64,800, \$639 per mo. 9.1% and owner will carry balance of \$29,700 at 10 1/2% interest. See today with MAYNARD TRISLER; follow W&W signs at 1st Ave. So. & Normandy Rd. (180th SW) or call him at 244-5900.

## WEST & WHEELER

REAL ESTATE SINCE '88  
401 S.W. 152nd 244-5900

"Quality Street" Financing Available

# Seawind

Private pond & dock. Artist conception.

Des Moines' complete condominium community...from \$36,500

Covered heated pool/Tennis court

- Covered parking
- Extra storage
- Extra soundproofing
- Thermo windows
- Covered heated swimming pool
- Recreation center with kitchen
- Tennis court
- Therapy pool & Sauna
- Oak cabinets
- Colony oak doors
- Parquet entries
- Washer & dryer
- Patio or deck
- Completely equipped kitchen
- Fireplace
- Cable TV

V.A. FINANCING LOW INTEREST for qualified buyers!

OPEN EVERYDAY NOON-6

Represented by **John L. Scott, Inc.** 878-1420 682-1760  
"Quality Street Condominium Marketing"

# REAL ESTATE NORTHWEST

FEATURING: HOMES, CONDOMINIUMS, COMMERCIAL INVESTMENTS, INDUSTRIAL SITES, RECREATIONAL PROPERTY, WATERFRONT, FARMS & ACREAGE, REAL ESTATE TRADES, BUSINESS OPPORTUNITIES, REAL ESTATE LOANS & MORTGAGES, INSURANCE, COMMERCIAL & RESIDENTIAL BUILDERS

## Mortgages on sale at 9%

If you've been waiting for someone to have a money sale, you've waited just long enough. Jack Stumph, branch manager of Benton-McCarthy's Redondo office, is acting as agent for the Pulte construction firm, and Pulte is having a money sale.

With 20 homes under construction in Twin Lakes X (pronounced Twin Lakes Ten), Pulte acquired a large forward commitment of mortgage money, so they are able to offer mortgages on these 20 homes as 9 percent. That's right, an old fashioned number like nine. Thought you'd never see it again, didn't you, with people arguing over 12's and 14's!

"Pulte is one of the nation's largest builders," Stumph says, "and this is their first entry into the Northwest, so they're putting their best foot forward. The price range on these homes is \$85,000 to \$100,000, and they are three or four bedrooms or

two or three levels, quite a few with Sound views. Their energy-saving features include double wall construction, double pane glass with wood wrapped windows, fireplaces, forced air electric heat. They have nice features in the construction like the floors being both glued and nailed so there are no squeaks."

Let's take a closer look at the mortgage. It's a five year mortgage amortized on a 30-year basis, so it amounts to the first five years of a 30-year mortgage. It is up to the buyer to refinance at any time during the five years when the more conventional mortgage rates are within his range. (Keep in mind that the national average is to move in less than five years, so for some families the question of refinancing will simply not arise.)

In addition to that very attractive rate on the interest,

Pulte is paying a lot of the front-end costs: the title insurance, escrow fee, loan origination fee, and a parcel of other one-time fees that either don't apply or Pulte is paying.

**WHAT THE BUYER** must pay up front are the fire insurance for a year, the starting of an escrow account for the taxes, the Twin Lakes home-owner's fee (\$11), and so on: not fees so much as costs any buyer must carry.

Ah, but what do I need down, you say? 10 percent will do, but of course 20 is better. Or with zero down, go VA. Let's take a look in detail at each possibility, applied to a house costing \$93,300. It's 1,398 square feet finished, 1,294 square feet of unfinished basement, four bedrooms.

The down payment is \$9,330 and those front-end costs are \$1,309 for a total of \$10,639. The loan amount is \$83,970, at an actual interest rate of 9.25 percent, the last quarter percent bearing Private Mortgage Insurance. Principal and interest is \$691. Allow taxes at \$50 per month and insurance at \$20 for a total monthly payment of \$761. Now comes the fun: \$697 of that \$761 is tax deductible because \$50 of it is taxes and \$647 is interest. At a marginal tax rate of 32 percent, \$223 comes off the family's taxes each month, leaving costs so far of \$538.

We're not done yet. Total mortgage payment of \$691 minus the interest of \$647 leaves \$44 each month which is applied toward the principal - in other words, that's yours, and it goes up a bit each month.

Remember the rising costs of homes? That's what's been bothering you all along about getting into one, right? Well, as soon as you buy into the market, that works in your favor. At a conservative estimate, houses in this area are going up by 1 percent per month, or 12 percent per year. This house can be estimated to be going up \$933 each and every month. And the \$44 to the \$933 for a total of \$977 each month, and subtract that from the \$538 we've already figured out that house is costing each month.

**ANY LITTLE KID** knows you can't subtract \$977 from \$538 because it doesn't work, but smart grownups realize that \$439 is a delightful sum to have a house cost each month. It means you are making \$439 each and every month you live in the house!

Let's swing quickly past the same house with 20 percent down. That quarter percent Private Mortgage Insurance drops out now, so the front end costs are now \$846 plus the 20 percent down for a total of \$19,506. The loan amount is \$74,640 and the actual mortgage rate is 9 percent, for a monthly principal plus interest payment of \$601. Taxes remain \$50, insurance remains \$20, for a total monthly payment of \$671.

Taking the same 32 percent marginal tax bracket, the \$610 that comes off the IRS statement each month is a savings of \$195. Put \$41 into the principal and use the same appreciation of \$933 per month, for an actual monthly cost of a delightful negative \$498.

But you say you've got nothing down at all? Pulte will accept VA financing on these homes, too, at the going VA rate of 10 1/2 percent.

Like any other sale, this one is of short duration. For three more weeks Stumph can act as salesman for the best money sale in the area. After that it's back to the regular prices - even a large commitment of money can't be held for long at less than market rates. Stumph's office phone is 941-6400 and his address is 27223 Pacific Highway S. If you've thought you were priced all the way out of the housing market, think again but don't wait too long!

**SWEEPING VIEW**  
Large 3 bedroom home, rec. room with wet bar, 2 baths, large deck. On magnificent Pickering Passage. Good salmon fishing, water skiing, boat launch, bike trails, hunting, etc. Near Shelton. Only \$89,500, for more information call Connie, 939-6416 after 5:30 weekends, or 1-426-4139.

**JUST MOVE IN**  
Yes, this one year beauty with finished basement and landscaped yard (back yard chain link fenced) has 4 bedrooms and 3 baths, rec room, 2 fireplaces, carpeting and drapes. Located between Saltwater State Park and Des Moines Marina. Only \$90,000. See by appt.  
"Over A Quarter Of A Century At 208th & 1st Ave. So."  
**JAMES E. KENNETT, REALTORS**  
878-3666

**Pacific West Properties OF FEDERAL WAY INC.**  
**LAKE WALKER \$27,500**  
Beautiful vacation setting, located on 1/2 acre of waterfront seclusion. Unique 1 bdr. cabin, landscaped for beach deck. Ad F117  
**FEDERAL WAY \$78,950**  
Mr. & Mrs. Clean will love the immaculate condition of this lovely home. 4 bdrs., 3 bath, 2 fireplaces, rec room and family room. Double garage, low maintenance yard. Ad F118.  
**SHY 1/2 ACRE \$79,950**  
Close to Burien, property large enough to accommodate one horse. This 3 bdrm., 2 full bath home is only one year old. Walking distance to shopping. Ad F127.  
**839-4700 or 927-5252**

**Century 21 We're Here For You**  
"The neighborhood professionals"  
**YOUNG HOMES REALTY, INC.**  
Member of 3 multiple services Now 7,700 offices

OVER 1,000 homes sold each month in Washington by Century 21 offices. If you need assistance ask for your Neighborhood Professional.

**????HALLOWEEN????**  
DON'T BE FRIGHTENED!!! WITH ALL WE READ AND HEAR THESE DAYS IT IS RATHER FRIGHTENING TO THINK OF MAKING ANY CHANGES—HOWEVER, THERE ARE STILL WILLING BUYERS AND WILLING SELLERS, WHO, THRU NECESSITY OR WISH, MUST MOVE TO ANOTHER HOME OR ANOTHER AREA. THE OPPORTUNITY IS STILL THERE AND OUR TRAINED NEIGHBORHOOD PROFESSIONALS ARE HERE TO HELP YOU FIND A WAY TO BUY THE HOME OF YOUR DREAMS. CALL YOUR CENTURY 21 NEIGHBORHOOD PROFESSIONAL AT 941-3000

**GHOSTS WON'T HAUNT THIS!!!**  
Sharp and clean and you can be moved in for the holidays if you hurry. Good area, close to freeway access and stores. 3 bdrms., RV parking, garage and now \$59,500.  
**GOBLINS WILL PLAY!!!!**  
In this super big back yard, all nicely landscaped and room to play. Lots of bedrooms for the little Goblins, lots of storage for cats & brooms. In one of the best neighborhoods and even has a view-move in quickly for \$93,500.

**ALL YOU WITCHES AND WARLOCKS**  
RIDE YOUR BROOMS OUT TO OUR OPEN HOUSE THIS WEEKEND. NOON TO DUSK  
EASTVIEW - 6 NEW HOMES SOUTH 292nd St. & 61st Ave. S. CUSTOM BUILT WITH VIEW

**SCARECROWS AND BLACK CATS**  
Or horses-Shy 2 acres with ranch rambler, 2 car garage, family room, 3 bdrms. and 3 baths \$55,900  
**NO SKELETONS IN THIS CLOSET**  
Area is terrific for getting to and from everything, walk to stores or bus 3 bdrms Fam Rm 2 car Gar and fully fenced backyard and for \$58,250  
**SPOOKY????????**  
No spooks here...3 bdrms. and mostly brick exterior on a large fenced backyard and backed up to woods. More room to expand downstairs and owner will leave greenhouse. View of Sound and Mts. \$75,500

**HAUNTED HOUSE**  
This brand new beauty needs someone to move in...it's cold and empty and lonesome...Bring your family and warm it up so it can be happy-under appraised value this custom beauty has lots of room to grow. \$80,500.  
**NO COBWEBS HERE!!!**  
Not even a sign of one and spiders wouldn't dare show their face in this darling "snow cold" rambler hidden away in Redondo. 3 bdrms., 1 bath, frpl., garage and all cyclone enclosed. \$59,500.  
**PUMPKIN PATCH**  
Enjoy the last of the garden in the fenced back yard of the "squeaky clean" colonial on a cul-de-sac in Twin Lakes area. 3 bdrms., 3 bath, with lots of amenities for \$79,900

**TRICK OR TREAT**  
Treat yourself to this "magazine" house in Twin Lakes, 4 bedrooms, 3 baths, large family room plus a large family kitchen with a lovely deck and privacy back yard and landscaped yard with literally no care, for \$84,500.  
**VIP NATIONWIDE SERVICE**  
Relocating... You need a friend who knows the territory. So, if you're moving in North America or Hawaii to Alaska - we have over 7,700 offices at your service. For a free market estimate or free V.I.P. relocation service, call 941-3000.  
**941-3000 30390 PACIFIC HWY SO. 927-9300**

**NORTH CAMPUS REALTY, INC.**  
32020 1st Ave. So., Suite 109  
Federal Way, WA 98003  
Seattle  
**838-4131**  
Tacoma  
**952-2223**

**JUST LISTED**  
**TRI-LEVEL \$68,000**  
Three bedroom, 2 bath tri with double pane windows and 2 car garage on a nice lot with the back yard fenced. View of Mt. Rainier.  
**UNDER APPRAISAL**  
Sound view Spanish rambler with basement. This is a must see to appreciate the many fine features in this energy efficient heat-keeper home that will appeal to the discriminating buyer. Now only \$152,000.  
**SALESPERSONS WANTED**  
NORTH CAMPUS REALTY - Has your interests in mind. We want you to succeed. We will help you get started right in Real Estate. One-on-one training for as long as you need, lots of new homes to sell, computer available, one of the best commission splits, dream office. Call Bob Boyd and get a free lunch just for talking it over. 952-2223 or 838-4131.  
**952-2223 or 838-4131**

**SUBURBIA AT ITS BEST**  
Watch the seasons unfold in this secluded, yet convenient, 2 bdrm. rambler. Almost 1/2 acre, lots of trees and privacy. Almost new home has plush carpeting throughout and energy saving features. A unique 3/4 high wall separates living room from kitchen, \$53,500 for the privacy and seclusion you've always wanted.  
**RUBY V. HILLER REAL ESTATE**  
**839-5777 or 952-4141**  
31260 Pacific Hwy. So.  
(Dana Plaza)

**RED CARPET**  
**STARTER HOME \$52,000**  
Well constructed 3 bedroom home. Home sits back off street to give feeling of privacy. Potential to be a very gorgeous, comfortable home with minor additions.  
**SUCH A DEAL!! \$75,000**  
Lovely 5 bedroom home with 2 baths sitting on a good size 1/2 acre lot. This home has 2 fireplaces and a gorgeous family room. Close to schools and shopping. Very lovely home inside and outside.  
**TOP OF THE WORLD**  
Spacious custom rambler with daylight basement. 3 bedrooms, 3 baths, family room, rec room with wet bar and room for a pool table. Spectacular view of Mt. Rainier and valley. A dream home for entertaining. More extras included than you can count.  
**RED CARPET**  
Sea-Tac Mall Realty, Inc.  
**941-3300 or 927-2012**

**CASH NOW**  
We buy 1st and 2nd Real Estate contracts and mortgages  
**PACIFIC COAST INVESTMENT CO.**  
**TACOMA 572-6824 SEATTLE 624-3440**

**OPEN HOUSE 1-5**  
**WEST CAMPUS NEW HOMES "0" DN. VA. or FHA TERMS**  
Quality brand new daylight basement homes. From \$75,550 to \$84,950. Offered to discriminating home buyers by United Homes in the Pacific Northwest's prestigious West Campus. These 3 and 4 bedroom homes feature deluxe oak veneer cabinetry, plush wall to wall carpeting and upgrade appliances. 10% down conventional financing also available. Model home open every day from noon til 8:00 p.m. From I-5 or Pac. Hwy. So. Drive west on So. 320th to 6th S.W. and turn left.  
**FIVE MILE LAKE CUSTOM BUILT HOME**  
Brand new 3 bedroom tri-level 2 1/2 bath, on large wooded homesite with private access to serene Five Mile Lake. Features two decks off rear, oak cabinets, skylights, brick floor to ceiling fireplace and more. 5 minutes to I-5 or Weyerhaeuser headquarters: \$97,500. DIRECTIONS: Drive south on Military Road So. to So. 372nd; turn right and follow signs to 3235 So. 366th St.  
**4 BEDROOM 2 STORY \$72,950**  
Absolutely immaculate 2 year old true two story home, beautifully landscaped and draped with separate family room within walking distance to schools. Can be purchased with only 10% down. Located in the newer Serenidad area of Federal Way. Transferred owner can be flexible on occupancy. Shown from office.  
**SOUTH KING REALTY**  
33100 Pacific Hwy. So.  
**838-3136 927-2641**

**"Become an Expert"**  
Sales training and guidance for all salespeople.  
**Spectacular Panoramic VIEW**  
Enjoy boat watching or just love water? 4 bedroom, 3 baths, family room, 2 fireplaces, and a 2 car garage. Luxurious beige tone carpet blends with glistening hardwood floors reflecting pride of ownership. \$105,000. Seller will consider Contract, Conventional, or VA terms.  
**NO TRICK**  
Just a real TREAT! Cozy Freshly Painted - 3 bedroom Rambler. Garage-Workshop area. Gigantic lot. FHA or VA \$48,950.  
**FHA-\$72,500-VA**  
5 bedroom basement rambler. Quiet Close-in location. Large Rec room, 2 Fireplaces, double garage. Well landscaped fenced yard.  
**REDUCED**  
Seller anxious Immaculate 4 bedroom, 1 3/4 bath, 2 fireplace, Rec room (pool table size) and Hobby Room. Walk to Steel Lake. \$72,450 FHA or VA. Try a Real Estate Contract.  
**FEDERAL WAY LAND & HOMES**  
22760 Marine View Drive South  
**CALL 824-7600**  
**54 International Real Estate Network Offices in Washington State**

**YOU ARE #1 REAL ESTATE NETWORK WITH US!**  
EVERY OFFICE INDEPENDENTLY OWNED & OPERATED  
**Open Sunday, 1 to 5, 21434 13th Ave. So.**  
4 bdrms are upstairs in this 2 story home. The main floor has a circular floor plan for convenient entertaining with fireplace in the cozy living room. Full basement. FHA, VA terms. \$70,500.  
**Open Sunday 1 to 5, 30453 10th So.**  
3 bdrm, 2 frpl, full basement home is located on wooded ravine affording a quiet private atmosphere, yet close to bus, schools, and shopping. Storm windows and loads of storage with room to expand. FHA & VA terms available. \$65,950.  
**WOODED PRIVACY**  
Tucked away back among the trees is this 3 bdrm home with luxurious master suite. Also has 2 baths, dbl garage & located near Federal Way, \$66,500.  
**EXECUTIVE 5 BEDROOM**  
Large colonial placed in a 1/3 acre private, wooded, country setting. Energy saving features and Contract Terms available, \$117,000.  
**ACREAGE**  
14.5 acres near Lake Morton, \$115,000. Contract terms available.  
**JOHN L. HALE REALTY**  
29233 Pacific Highway So.  
**CALL 839-4800**

**8 1/2 % ASSUMABLE LOAN**  
4 Bdrms, 3 baths, large rec room with wet bar all this plus a quiet den. Dbl gar. and even a dog run. Great for entertaining. Ad #364R Today call 246-3293.  
**WEST SEATTLE DOUBLE DET GAR.**  
2 Bdrms. Top area \$51,500 Ad #340R 246-3293.  
**SELLING**  
Complimentary Market Evaluations  
**CIRCLE THIS ONE**  
\$40,950  
FIXER UPPER  
3 Bdrms Basement Garage New Furnace Ad #365R Call 246-3293.  
**LARGE LOT 4 BEDROOMS**  
Nearly a city acre surrounds this country style home. 2850 sq. ft. spread out over three levels with all kinds of home and land potential. Play safe huge yard-the kids & pets will love it. Easy walk to school, bus & shopping. \$79,900 Ad #308R 246-3293  
**FRAZIER REALTY INC.**  
15031 Military Road South  
**CALL 246-3293**



# REAL ESTATE NORTHWEST



FEATURING: HOMES, CONDOMINIUMS, COMMERCIAL INVESTMENTS, INDUSTRIAL SITES, RECREATIONAL PROPERTY, WATERFRONT, FARMS & ACREAGE, REAL ESTATE TRADES, BUSINESS OPPORTUNITIES, REAL ESTATE LOANS & MORTGAGES, INSURANCE, COMMERCIAL & RESIDENTIAL BUILDERS

## Vandaveer attends C-21 seminar

Sherman R. Vandaveer of Century 21 Burien Realty, Inc. was one of more than 178 Century 21 brokers, owners, and managers who recently completed

a four-day Century 21 International Management Academy in Newport Beach, California.

The seminar is designed to introduce all new Century 21 affiliated brokers and managers to the advanced marketing tools and systems that Century 21 offers to help brokers and sales people better serve their client's needs.

Century 21 is an international real estate organization with more than 7,000 affiliated, inde-

pendently owned real estate offices throughout the United States and Canada. Among the advanced marketing systems Century 21 offers its member brokers and salespeople is a detailed training program held in 50 regional training centers throughout North America, recruiting through regional career nights, and an international VIP Referral Service to aid in marketing property. Also, \$18 million is earmarked for television, radio and print advertising each year to alert the public to the vast array of services each member Century 21 office provides.

Vandaveer has been in real estate sales in South King County since

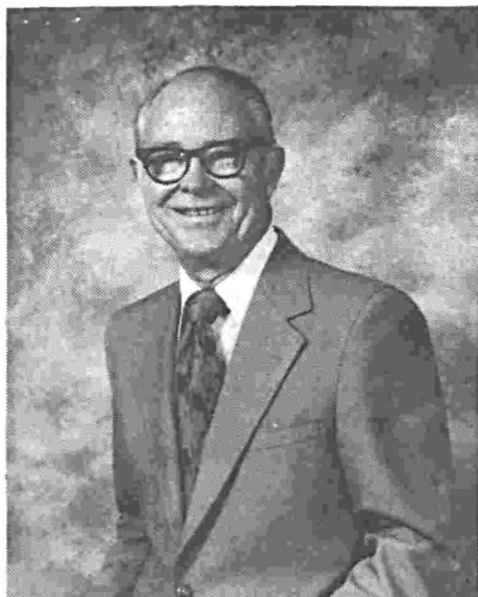

Sherman Vandaveer

January, 1970. He is co-owner and broker of Century 21 Burien Realty, Inc. a member of Burien-White

Center Rotary club, a member of Seattle Consistory, and Southgate Lodge 247, A.F...A.M.

**Classified ads**

**CALL 839-9520**

## Wallace & Wheeler, Inc.

"Excellence in Performance"

**PRICE REDUCED \$10,000 ON NEW HOMES**

Two custom-styled 3 bedroom, 3 bath homes, each on 2 1/2 acre lot. Spacious contemporary 2 story now \$114,950, and fashionable tri-level \$99,950. Call 941-2651. #680

**3 BEDROOM TRI-LEVEL \$69,950**

Assume VA Loan on this 1976 quality built home quiet cul-de-sac in desirable area of fine homes. Call 941-2651. #681

**CHARM & QUALITY OFF DASH PT. ROAD**

Spacious 6 bedroom, 3 bath home for an active family on its own private lake and .9 acre of total seclusion. Covered pool and much more. Owner looking at all offers - \$169,500. Call 941-2651. #682

**OWNER PAYS YOUR CLOSING COSTS**

Picture a quiet wooded area, good family neighborhood and you have the setting for this inviting house. It is immaculate inside and out. It has 3 bedrooms, 1-3/4 baths, fireplace, family room, double garage with automatic opener, all the things you've been looking for in that special home. Call for showing at 941-2651. #683

**SALE FAILED-OWNER SAYS "GET ON WITH IT!"**

This 4 bedroom, 2 bath house needs a new owner. There's lots of room for a large family with a full daylight basement and a large lot. Fireplace for these rainy evenings and a handy location near schools and shopping. Call now on this one at 941-2651. #684

Serving the South end from West Seattle to Tacoma  
**30837 Pac Hwy So. 941-2651 927-3518**

## FRIEND TELLS FRIEND

TO BUY OR SELL REAL ESTATE CALL BENTON McCARTHY REALTY, CITY & CASCADIA VIEW



**BUCK BUCHOLZ**  
Call Buck Bucholz at 246-8033 or 243-6541 eves.

Tell a friend to call Airport Branch 246-8033  
**BENTON-McCARTHY REALTY, INC. Better Homes and Gardens**

**MORE REAL ESTATE ON FOLLOWING PAGE**



## Poverty Bay Real Estate, Inc.



**THIS WON'T LAST! ZERO BANK WATERFRONT!**

Let us show you this unique designer home w/soaring cedar ceilings & clerestory windows. Sweeping sound & Mt. view from both levels-direct auto access-dedicated park surroundings. Beach club w/tennis courts & boat ramp. Great investment! Call Poverty Bay R.E., 878-1960-eves. 824-5271.

**INVESTOR'S DELIGHT**

Des Moines area-house needs repairs, but this 2 story, 3 bedroom, 1 1/2 bath could be something special-priced in the 50's-call Poverty Bay, 878-1960 for an appointment.

**CALL US FOR EXCLUSIVE WATERFRONT LISTING!**

PHONE: (206) 878-1960  
22770 Marine View Dr. So.

## SELLING YOUR HOUSE



**By Doug Fields**

**WHO WANTS YOUR HOUSE?**

Somewhere, out there, there must be a buyer for your property, someone who's looking for a home with just the features that your house has. But how are you going to find him?

Chances are, that buyer has already started looking for a home. How are you going to find him before he finds ANOTHER house and passes yours up?

When a would-be buyer comes to town, he heads for where the homes are: the office of a professional real estate agent. The buyer knows he'll find the widest selection of properties that meet his needs in the hands of an expert. He won't have to waste time looking at houses that don't measure up.

Maybe your buyer registered with us yesterday, or last week. He's told us what he wants and needs, and what he is prepared to pay. The vital statistics may match your house exactly. But you'll never know unless you call.

You're as smart as a smart buyer. When you want to sell, go where the prospects are.

**SOUTH KING REALTY**  
33100 Pacific Hwy. So.  
838-3136 927-2641

## "Quality Street" John L. Scott, Inc.

<p><b>WEST SEATTLE \$146,000</b> This fine old home has one of the most unobstructed views of Seattle, Elliott Bay, the Cascade Mountains and Mount Rainier possible. Call Forrest LaMotte 937-9000 for VIDIO PREVIEW appointment.</p> <p><b>SHOREWOOD \$167,500</b> 2 story brick &amp; cedar Colonial. 180° Sound &amp; Mountain view. 4 bedrooms, 3 baths, recreation room, large deck, 2 patios, lots of storage. Call Herb Roberts for VIDIO PREVIEW 246-0344 or 243-0241.</p> <p><b>NORMANDY PARK \$115,000</b> Picturesque Oriental garden sets the mood for this custom 4 bedroom, contemporary rambler. Generous formal dining, ranch style kitchen, walk-in pantry &amp; sunken living room are some of the pluses. Call Liz Armstrong 246-0344 for VIDIO PREVIEW.</p>	<p><b>NORTH ADMIRAL \$180,000</b> Watch the sparkle of City lights and harbor traffic on Elliott Bay from this new 3 bedroom 2 1/2 bath Northwest contemporary home. Many quality extras including green house windows and skylights. Call Richard Motter 937-9000 for VIDIO PREVIEW appointment.</p> <p><b>FEDERAL WAY \$69,950</b> Deluxe townhouse! Quiet Forest in West Campus! 3 bedrooms, 2 1/2 baths, beautiful carpeting all appliances, less than a year old. Green belt. Call 839-6650/927-7600.</p> <p><b>LAKE TAPPS ACREAGE \$135,000</b> Gorgeous, large quality contemporary on acre homesite. Mt. Rainier view, waterfront privileges. Everything for a family with children. Call 839-6650/927-7600.</p>
--	--

West Seattle 3221 California Ave SW 937-9000  
Burien 16000 1st Ave S 246-0344  
Federal Way 30640 Pacific Hwy S 839-6650  
Kent 25052 104th SE 854-9523

**"Quality Street"**  
"20 offices serving the greater Puget Sound area."

## THE FIRST REALTOR IN FEDERAL WAY

**C. Ralph Fleming**  
"NOW IN OUR 32ND YEAR"



**CAPTIVATING!**  
Inviting 4 bdrm in absolutely spotless condition - 2 fireplaces, 3 baths, lovely fam rm, formal din rm, dream kitchen, wall to wall carpet - nice, quiet, Edgewood area - call for app't today!

**ARE YOU A BIG FAMILY?**  
Lovely large 5 bedroom, 3 bath has fireplace, loads of storage, nice yard and covered patio, in good close-in Auburn location, asking only \$69,500.00

**SPANKING NEW 3 BEDROOM**  
Quality built little jewel on good size wooded lot in Bonney Lake area. . . walnut kitchen cabinets, decorator color bath, wall to wall carpet, vaulted ceilings, sliding glass door to large deck, call today at only \$45,500.00

"Member of National Home Relocation Service"  
31250 Pacific Hwy. So  
839-3400 927-0550

## OPEN SUNDAY 1-5

**WE DARE YOU** to find better built homes (new!), better prices (from \$57,950), better terms (FHA, VA, seller pays closing costs on selected homes), or better area (Centennial Park off Hoyt Rd.) Follow Evergreen signs!

**NO "TRICKS"** just "treats" offered by this fabulous new 3 bedroom, 1 1/4 bath home! View Sound and Mts. \$89,900! In Redondo at 27828 10th Ave. S. (across from "castle")

**FACTS, NOT FICTION**—exceptionally clean 3 bedroom, 2 bath home professionally decorated in Twin Lakes can be had for \$70,500 and FHA/VA terms! 32736 33rd Ave SW.

**THE TERMS YOU'RE LOOKING FOR--FHA, VA** are found in the perfect family home! 4 bdrms., 1 1/4 baths, fireplace, more! Walk to schools, church! \$65,000! 805 S. 309th Pl.

**31343 IS YOUR LUCKY NUMBER TODAY!** This immaculate 3 bdrm. rambler on landscaped corner lot at 31343 31st Ave. SW is waiting for a deserving buyer like you! Come see it now! \$72,500.

**CALL TO SEE** excellent larger than average 4 bdrm., 1 1/4 bath tri-level! FHA, VA, assume!! \$79,950!

☆ **DON'T WASTE GAS BY GETTING LOST! STOP BY OUR OFFICE FOR FREE AREA MAP!** ☆

**EVERGREEN REALTY, INC.**  
33427 Pacific Hwy. S.  
838-2800 927-7313

## BENTON'S REALTY INC.

**DO YOU KNOW WHAT YOUR HOME IS WORTH ON TODAY'S MARKET?**

NAME \_\_\_\_\_ PHONE \_\_\_\_\_  
ADDRESS \_\_\_\_\_  
CITY \_\_\_\_\_ STATE \_\_\_\_\_ ZIP \_\_\_\_\_  
Cash value 1/20th cent FREE MARKET ANALYSIS  
Call us -- we'll tell you the fair price!

<p><b>FHA \$50,000</b> Already appraised and ready for occupancy! Attractive 2 BR with fireplace in pleasant neighborhood. Large treed lot with fenced yard and extra storage. Call 243-8400 to see Ad S-35.</p> <p><b>NORMANDY PARK \$125,000</b> Beautiful 4 BR home, daylight basement, 2 baths, double garage, plush throughout! Ad-joins Normandy Park community beach, tennis courts, and club house. FENCED FOR HORSES! Call 243-8400 for appt. to see Ad S-36.</p> <p><b>AIRPORT OFFICE</b> 16015 Pacific Hwy. So. 243-8400</p>	<p><b>EXCELLENCE \$59,950</b> You will fall in love with this 3 br. in excellent area, close to everything, lg. lot with nice patio, super rec. rm. and lg. storage area. Call 839-5300 on ad F-789</p> <p><b>TWIN LAKES \$84,950</b> Immaculate 4 br. on quiet cul-de-sac, large treed lot, fam. rm., 2 fireplaces, formal dining room. Totally finished, just waiting for you. Call 839-5300 on ad F-790</p> <p><b>FEDERAL WAY OFFICE</b> 31811 Pacific Hwy. So. 839-5300</p>
---	---

**BENTON'S REALTY INC.**

## SPARTUS CORPORATION

<p><b>COUNTRY CLUB \$84,950</b> 4 bedrooms, 3 baths, huge family kitchen with elegant cabinets that you would expect in an executive home. Of course, the lower level rec rm is finished. This huge tri-level is fenced, treed and landscaped to perfection. Built in 1974 for today's living! All under a heavy shake roof. For appointment call Roy Gage 838-9933, 927-3280.</p> <p><b>WATERFRONT! \$159,000</b> An opportunity to have your own moorage for your private yacht. 80 feet of Puget Sound waterfront, 180 degrees of unobstructed view. Ideal home for entertaining, extra large rec rm, 5 bedrooms 2 3/4 baths. Call Gertrude Scott 838-9933, 927-3280.</p> <p><b>WE HAVE ACCESS TO OVER 1,000 PROPERTIES CALL US NOW!</b> 838-9933 3400 S.W. 320th 927-3280</p>	<p><b>LAND \$42,000</b> 12 acres of wooded recreation land with view of the Olympics. Five miles from the south end of Hood Canal and approximately five miles from Twanoh State Park. Call Vivian Potter 838-9933, 927-3280.</p> <p><b>TWIN LAKES SPLIT LEVEL \$76,500</b> The owner of this lovely split level is retired and wants to move. This home has never heard the patter of little feet but it would love to! It offers your kiddies a large fenced back yard, 3 bdrms., oversize rec rm and an elementary school 2 blocks away. Bring your family to see it! Call Nelda Griffin or Jim Payne for an appointment 838-9933, 927-3280.</p>	<p><b>LARGE FENCED YARD! \$84,950</b> Super assumption in area of prestigious homes. This excellent family home has 4 bdrms. and 2 1/2 baths. The large fenced back yard has plenty of room for an outdoor pool or hot tub! This tri-level sits on a quiet cul-de-sac. Call Gertrude Scott 838-9933, 927-3280.</p> <p><b>DAY DREAMING? \$145,000</b> Are you dreaming about a home you can't believe exists? This one does exist and has the most glorious view of Puget Sound plus the prestigious Twin Lakes golf course! Walk-in closets for all 3 bedrooms and the biggest master suite you've ever seen! Luxury plus! Call Vivian Potter 838-9933, 927-3280.</p>
---	---	---

**SPARTUS**









EFFECTIVE OCT. 28 & 29, 1979  
SUNDAY and MONDAY

OPEN DAILY  
9-10  
SUNDAY  
10-7

# Kmart®

REGULAR PRICES MAY VARY STORE TO STORE

THE SAVING PLACE



**K mart® ADVERTISED MERCHANDISE POLICY**  
Our firm intention is to have every advertised item in stock on our shelves. If an advertised item is not available for purchase due to any unforeseen reason, K mart will issue a Rain Check on request for the merchandise to be purchased at the sale price whenever available or will sell you a comparable quality item at a comparable reduction in price. Our policy is to give our customers "satisfaction always".

# PRICEBREAKERS



**\$3** Our Reg. 4.57  
**Long Sleeve Acrylic Sport Top**  
Great to wear alone or teamed up for the fashionable layered look. Easy care acrylic in the latest fall colors. Misses sizes.



**1.77** 4-pr. Pkg. Our Reg. 2.33  
**Soft 'Booties' with Orlon®**  
Brushed Orlon® acrylic/stretch nylon in misses' size 9-11.  
\*DuPont Reg. TM



**\$4** Our 5.97  
**Men's Knit Sweater Vest**  
Soft acrylic in handsome solid colors. Save now.

**\$8** Our 12.96  
**Men's Dress Jeans**  
Polyester/cotton. Solids. Men's Sizes.



**58¢** Box of 20 Our Reg. 88¢  
**Fabric Softener**  
9x11" fabric-softener sheets to toss in the dryer. Save.

**74¢** Our Reg. 1.38  
**Spray Disinfectant**  
Helps eliminate odors, mold and mildew. 13-oz.\* spray can.  
\*Net wt.

**1.97** Our Reg. 2.47 Ea.  
**Choice of Bakeware**  
Quality aluminum bakeware with easy-clean, non-stick coating.

**88¢** Ea. Our Reg. 1.08 Ea.  
**Pkg. Of 100 Lunch Bags**  
Flat bottom brown paper bags, 5 1/2 x 3 1/2 x 10 1/2". Shop at Kmart.

**88¢** Our Reg. 1.22  
**Ovaltine® Cocoa Mix**  
Easy! Just add hot water. Box of 10 envelopes, 1 ounce\* ea.  
\*Net wt.

**1.69** Steam Table Hours May Vary  
**Spaghetti Luncheon**  
Spaghetti w/meat sauce, cole slaw, roll and butter.

**84¢** Each  
**Plastic Ware**  
Choose plastic dishpan or toilet brush and holder in colors.

**\$3** 27x48" Ea. Our Reg. 4.26  
**Carpet Remnants**  
Excellent choice of fabrics, colors and styles. Serged ends.

**3 Bars For 43¢**  
**Jergens® Hand Soap**  
You'll like this fragrant, lotion-mild soap in 3-oz.\* bars. Save now.  
\*Net wt.

**97¢** Ea. Our Reg. 1.22  
**Romance Paperbacks**  
3-in-1 novels in large-format size. Your choice of titles. Save now.

**68¢** Pkg. Our Reg. 94¢  
**Bow and Hank Assort.**  
Decorate any gift. Buy now and save.

**2 For \$5** Our Reg. 3.97  
**Mexican Pots**  
Hand painted 10" Mexican clay pots. Use inside or out.

**39.88** #60-291  
**Tempered Glass Tub Enclosure**  
Clear styrene panels install easily to 4 1/2 x 5' tub.  
Not Available in Renton, West Seattle, Lakewood, Tacoma-72nd

**68¢** Our Reg. 98-1.27  
**Storm Cover Kits**  
Durable polyethylene sheet with framing strips and tacks.  
Window Cover is 3x6' by 1 1/4"-Mil.  
Door Cover is 3x7' by 4-Mil.

**49.88**  
**Firebird® I And Electric Heat Dispenser**  
**2 Days Only**  
Lets heated air travel rapidly through tubing and out into your room.

**69¢** Our Reg. 96¢  
**Orange Plastic Flashlight**  
Great for home or auto. Can be found at Sporting Goods Department. Batteries not included.

**2 For \$3**  
**Wiper Blades or Refills**  
Choose 2 windshield wiper blades or 2 pair refills in sizes to fit most U.S. or foreign cars. Our 7.97, Windshield Washer Pump... 5.88

**2.69** 2 Days Only  
**Kodak® Slide Film**  
Your choice Kodachrome 25 or Kodachrome 64. 36 exposure.

**\$1 Off**  
**Watchband Trade-In Sale**  
Get \$1 off any K-flx watchband when you trade-in your old band. Charge it.

**9.97**  
**GE® Steam-and-Dry-Iron**  
25 vents for overall steam distribution. Heat-select dial. Comfort-contour handle.

**4.66** 2 Days Only  
**Monopoly®**  
Parker Brothers® famous real-estate trading game. The world's most popular game.

**32.96** Each  
**Electronic Football or Basketball**  
For 1 or 2 players. Ages 8 to adult. Requires one 9 volt battery\*. Battery not included.

- 24800 W VALLEY HWY KENT
- 15015 MAIN ST BELLEVUE
- 5401 - 100th SW LAKEWOOD
- 4141 MARTIN WAY LACEY OLYMPIA
- 8102 EVERGREEN WAY EVERETT
- 5132 - 6th AVE TACOMA
- 22511 HIGHWAY 99 EDMONDS
- 440 RAJMIER AVE SO RENTON
- 4210 WHEATON WAY BREMERTON
- 1207 SO 320th FEDERAL WAY
- 621 RIVER ROAD PUYALLUP
- 72nd & PORTLAND TACOMA
- 7345 DELRIDGE WAY WEST SEATTLE
- 1001 E SUNSET DR BELLINGHAM
- 13200 AURORA AVE SEATTLE